

CALIFORNIA COASTAL COMMISSION

South Coast Area Office
200 Oceangate, Suite 1000
Long Beach, CA 90802-4302
(562) 590-5071

Permit Application No. 5-02-266

Date: September 18, 2002

Page 1 of 6

**Item Tu4b****ADMINISTRATIVE PERMIT****APPLICANT:** Ardis Freeman Trust**RECORD PACKET COPY****PROJECT DESCRIPTION:** Replace existing floating dock, piles and gangway with new gangway, piles and floating dock in same location.**LOCATION:** 23 Vista del Golfo, Naples Island, City of Long Beach, Los Angeles County.**EXECUTIVE DIRECTOR'S DETERMINATION:** The findings for this determination, and for any special conditions, appear on subsequent pages.

NOTE: P.R.C. Section 30624 provides that this permit shall not become effective until it is reported to the Commission at its next meeting. If one-third or more of the appointed membership of the Commission so request, the application will be removed from the administrative calendar and set for public hearing at a subsequent Commission meeting. Our office will notify you if such removal occurs.

This permit will be reported to the Commission at the following time and place:

Tuesday, October 8, 2002, 10:00 a.m.
Eureka Inn
518 Seventh Street
Eureka, CA 95501

IMPORTANT - Before you may proceed with development, the following must occur:

Pursuant to 14 Cal. Admin. Code Sections 13150(b) and 13158, you must sign the enclosed duplicate copy acknowledging the permit's receipt and accepting its contents, including all conditions, and return it to our office. Following the Commission's meeting, and once we have received the signed acknowledgement and evidence of compliance with all special conditions, we will send you a Notice of Administrative Permit Effectiveness.

BEFORE YOU CAN OBTAIN ANY LOCAL PERMITS AND PROCEED WITH DEVELOPMENT, YOU MUST HAVE RECEIVED BOTH YOUR ADMINISTRATIVE PERMIT AND THE NOTICE OF PERMIT EFFECTIVENESS FROM THIS OFFICE.

PETER DOUGLAS
Executive Director

By: Charles R. Posner
Title: Coastal Program Analyst

STANDARD CONDITIONS:

1. Notice of Receipt and Acknowledgment. The permit is not valid and development shall not commence until a copy of the permit, signed by the permittee or authorized agent, acknowledging receipt of the permit and acceptance of the terms and conditions, is returned to the Commission office.
2. Expiration. If development has not commenced, the permit will expire two years from the date this permit is reported to the Commission. Development shall be pursued in a diligent manner and completed in a reasonable period of time. Application for extension of the permit must be made prior to the expiration date.
3. Interpretation. Any questions of intent or interpretation of any term or condition will be resolved by the Executive Director or the Commission.
4. Assignment. The permit may be assigned to any qualified person, provided assignee files with the Commission an affidavit accepting all terms and conditions of the permit.
5. Terms and Conditions Run with the Land. These terms and conditions shall be perpetual, and it is the intention of the Commission and the permittee to bind all future owners and possessors of the subject property to the terms and conditions.

SPECIAL CONDITIONS: See Page Four.

EXECUTIVE DIRECTOR'S DETERMINATION (continued):

The Executive Director hereby determines that the proposed development is a category of development which, pursuant to PRC Section 30624, qualifies for approval by the Executive Director through the issuance of an Administrative Permit. Subject to Standard and Special Conditions as attached, said development is in conformity with the provisions of Chapter 3 of the Coastal Act of 1976 and will not have any significant impacts on the environment within the meaning of the California Environmental Quality Act. If located between the nearest public road and the sea, this development is in conformity with the public access and public recreation policies of Chapter 3.

FINDINGS FOR EXECUTIVE DIRECTOR'S DETERMINATION:

A. Project Description

The proposed project involves the rehabilitation of an existing residential boat dock on Naples Island in southeast Long Beach (Exhibit #2). The existing U-shaped dock would be removed and replaced with a new floating dock about fifteen feet west of the existing dock's location. All three existing guide piles will be relocated in order to support the proposed dock in the new location. The proposed new dock is the same shape as the existing U-shaped dock, but has longer fingers that extend to the City's Pierhead Line limit (Exhibit #3). A new 3'x 20' gangway

ramp is proposed will be installed, and the existing 4'x 4' landing will be repaired as necessary and retained in place to provide access to the private dock.

The proposed project is in Alamitos Bay, situated between a vertical seawall and the City Pierhead Line (Exhibit #3). The proposed dock is associated with the adjacent single family home and is for boating recreation purposes only. The proposed project will not interfere with public access along the walkway that exists immediately inland of the seawall. The submerged site has not been surveyed for eelgrass. However, the National Marine Fisheries Service has found that eelgrass is not usually found within dock areas situated directly adjacent to the Naples Island seawalls with no inter-tidal beach zones (like this site). The proposed project has received an "Approval in Concept" stamp from the City of Long Beach Planning Department and the City of Long Beach Marine Bureau. The applicant is in the process of applying for permits from the U.S. Army Corps of Engineers and the California Regional Water Quality Control Board.

B. Marine Resources

The proposed recreational boat dock development and its associated structures are an allowable and encouraged marine related use. The project design includes the minimum sized pilings and the minimum number of pilings necessary for structural stability. The pilings are self-mitigating. There are no feasible less environmentally damaging alternatives available. As conditioned, the project will not significantly adversely impact eelgrass beds and will not contribute to the dispersal of the invasive aquatic algae, *Caulerpa taxifolia*. Further, as proposed and conditioned, the project, which is to be used solely for recreational boating purposes, conforms with Sections 30224 and 30233 of the Coastal Act.

C. Water Quality

The proposed dock work will be occurring on or within coastal waters. The storage or placement of construction material, debris, or waste in a location where it could be discharged into coastal waters would result in an adverse effect on the marine environment. To reduce the potential for construction related impacts on water quality, the Commission imposes special conditions requiring, but not limited to, the appropriate storage and handling of construction equipment and materials to minimize the potential of pollutants to enter coastal waters and for the use of on-going best management practices following construction. As conditioned, the Commission finds that the development conforms with Sections 30230 and 32031 of the Coastal Act.

D. Local Coastal Program

The Commission certified the City of Long Beach LCP on July 22, 1980. The proposed project is an improvement to an existing residential dock on submerged lands. Therefore, a coastal development permit is required from the Commission for the portion of the proposed development that is located within the Commission's area of original jurisdiction. The Commission's standard of review for the proposed development is the Chapter 3 policies of the Coastal Act. The City of Long Beach certified LCP is advisory in nature and may provide guidance. As conditioned, the proposed development is consistent with Chapter 3 of the Coastal Act and with the certified LCP for the area.

E. California Environmental Quality Act (CEQA)

As conditioned, there are no feasible alternatives or feasible mitigation measures available which would substantially lessen any significant adverse effect which the activity may have on the environment. Therefore, the Commission finds that the proposed project, as conditioned to mitigate the identified impacts, is the least environmentally damaging feasible alternative and can be found consistent with the requirements of the Coastal Act to conform to CEQA.

SPECIAL CONDITIONS:

1. Permit Compliance

The permitted use of the approved development is for boating related uses only. No boat baths or other type of permanent development is permitted to occupy the boat docking area between the dock fingers. All development must occur in strict compliance with the proposal as set forth in the application for permit, subject to any special conditions. Any deviation from the approved plans, no matter how minor, must be submitted for review by the Executive Director to determine whether an amendment to this coastal development permit is required.

2. Construction Responsibilities and Debris Removal

- a) No construction materials, equipment, debris, or waste will be placed or stored where it may be subject to wave, wind, or rain erosion and dispersion.
- b) Any and all construction material shall be removed from the site within ten days of completion of construction and disposed of at an appropriate location.
- c) Machinery or construction materials not essential for project improvements are prohibited at all times in the subtidal or intertidal zones.
- d) If turbid conditions are generated during construction, a silt curtain will be utilized to control turbidity.
- e) Floating booms will be used to contain debris discharged into coastal waters and any debris discharged will be removed as soon as possible but no later than the end of each day.
- f) Divers will recover non-buoyant debris discharged into coastal waters as soon as possible after loss.

3. Best Management Practices (BMP) Program

By acceptance of this permit, the applicant agrees that the long-term water-borne berthing of boat(s) in the approved dock and/or boat slip will be managed in a manner that protects water quality pursuant to the implementation of the following BMPs.

a) Boat Cleaning and Maintenance Measures:

1. In-water top-side and bottom-side boat cleaning shall minimize the discharge of soaps, paints and debris.
2. In-the-water hull scraping or any process that occurs under water that results in the removal of paint from boat hulls is prohibited. Only detergents

and cleaning components that are designated by the manufacturer as phosphate-free and biodegradable shall be used, and only minimal amounts shall be used.

3. The applicant shall minimize the use of detergents and boat cleaning and maintenance products containing ammonia, sodium hypochlorite, chlorinated solvents, petroleum distillates or lye.

b) **Solid and Liquid Waste Management Measures:**

All trash, recyclables, and hazardous wastes or potential water contaminants, including old gasoline or gasoline with water, absorbent materials, oily rags, lead acid batteries, anti-freeze, waste diesel, kerosene and mineral spirits shall be disposed of in a proper manner and shall not at any time be disposed of in the water or gutter.

c) **Petroleum Control Management Measures:**

Oil absorbent materials should be examined at least once a year and replaced as necessary. The applicant shall recycle the materials, if possible, or dispose of them in accordance with hazardous waste disposal regulations. The boaters shall regularly inspect and maintain engines, seals, gaskets, lines and hoses in order to prevent oil and fuel spills. Boaters shall to use preventive engine maintenance, oil absorbents, bilge pump-out services, or steam cleaning services as much as possible to clean oily bilge areas. Bilges shall be cleaned and maintained. The use of detergents or soaps that can be discharged by bilge pumps is prohibited.

4. Public Access along the Waterway

The proposed project shall not interfere with public access and use of the Vista del Golfo public walkway.

5. Pre-Construction *Caulerpa Taxifolia* Survey

- a) Not earlier than ninety (90) days nor later than thirty (30) days prior to commencement or re-commencement of any development authorized under this coastal development permit (the "project"), the applicant shall undertake a survey of the project area and a buffer area at least 10 meters beyond the project area to determine the presence of the invasive alga *Caulerpa taxifolia*. The survey shall include a visual examination of the substrate.
- b) The survey protocol shall be prepared in consultation with the Regional Water Quality Control Board, the California Department of Fish and Game, and the National Marine Fisheries Service.
- c) Within five (5) business days of completion of the survey, the applicant shall submit the survey for the review and approval of the Executive Director, and to the Surveillance Subcommittee of the Southern California Caulerpa Action Team (SCCAT). The SCCAT Surveillance Subcommittee may be contacted through

William Paznokas, California Department of Fish & Game (858/467-4218) or
Robert Hoffman, National Marine Fisheries Service (562/980-4043).

- d) If *Caulerpa taxifolia* is found within the project or buffer areas, the applicant shall not proceed with the project until 1) the applicant provides evidence to the Executive Director that all *C. taxifolia* discovered within the project and buffer area has been eliminated in a manner that complies with all applicable governmental approval requirements, including but not limited to those of the California Coastal Act, or 2) the applicant have revised the project to avoid any contact with *C. taxifolia*. No revisions to the project shall occur without a Coastal Commission approved amendment to this coastal development permit unless the Executive Director determines that no amendment is legally required.

ACKNOWLEDGMENT OF PERMIT RECEIPT/ACCEPTANCE OF CONTENTS:

I/We acknowledge that I/we have received a copy of this permit and have accepted its contents including all conditions.

Applicant's Signature

Date of Signing

End/cp

City of Long Beach

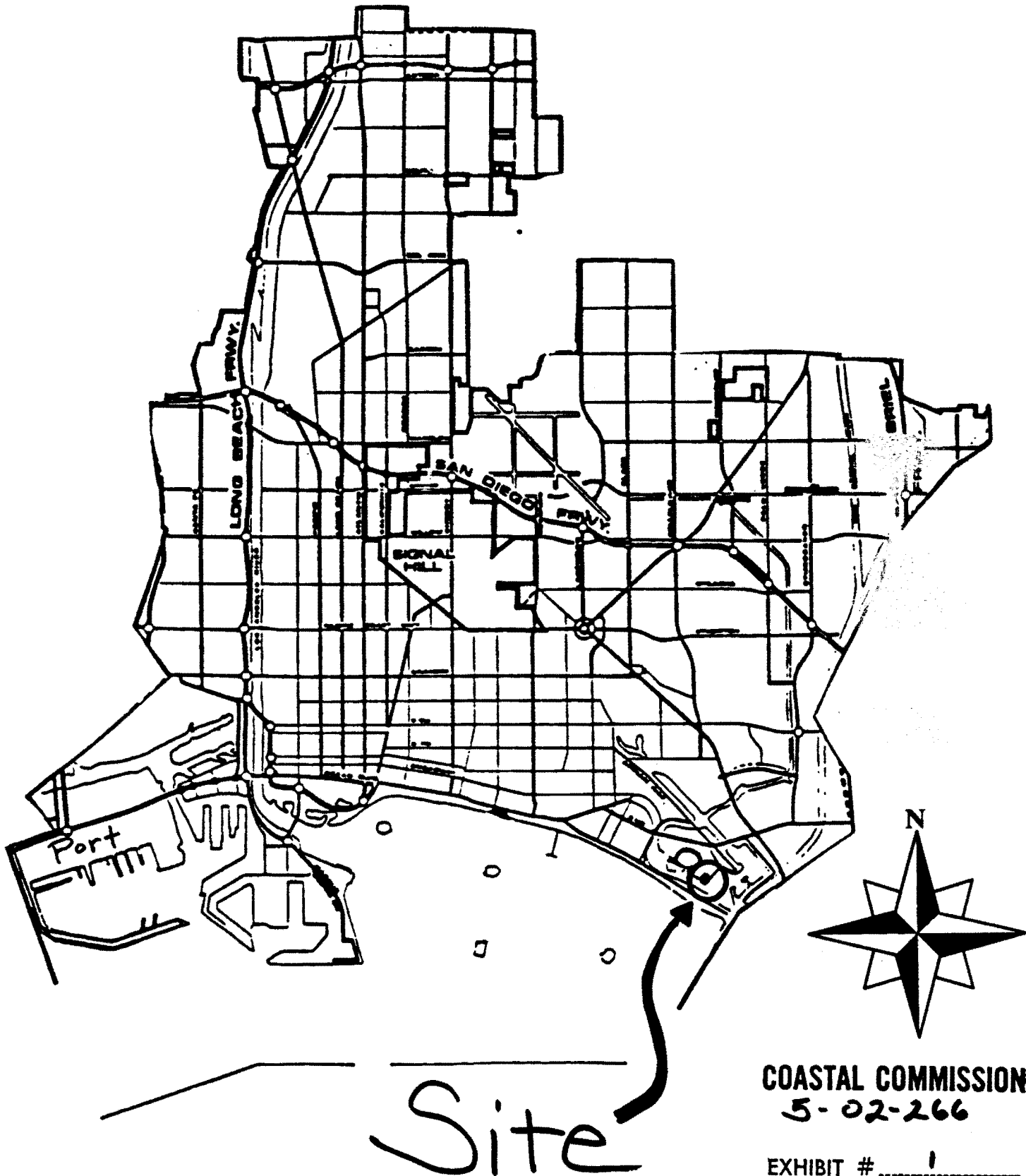

COASTAL COMMISSION
5-02-266

EXHIBIT # 1

PAGE 1 OF 1

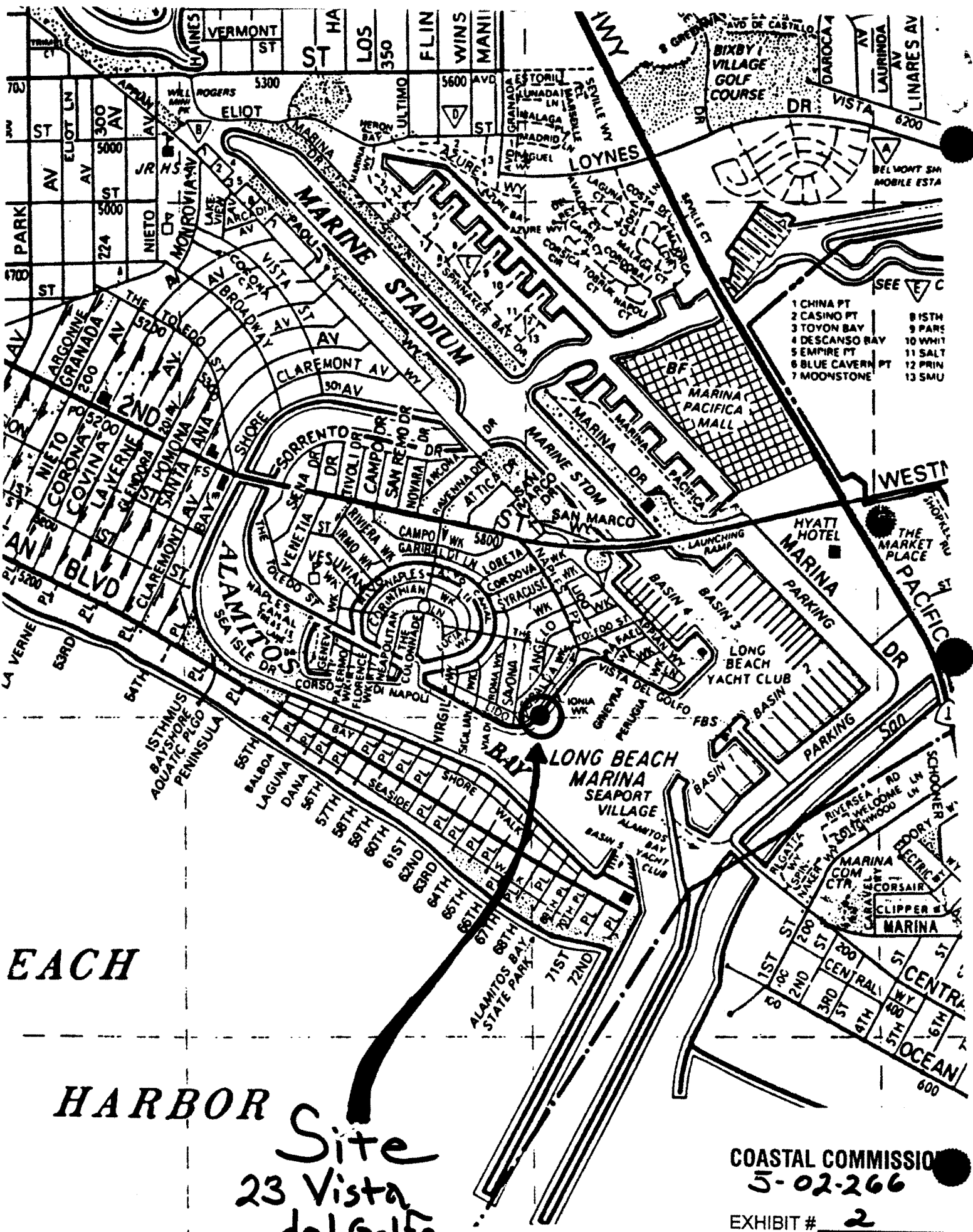

EACH

HARBOR Site
23 Vista
del Golfo

COASTAL COMMISSION
5-02-266

EXHIBIT # 2
PAGE 1 OF 1

CALIFORNIA
COASTAL COMMISSION

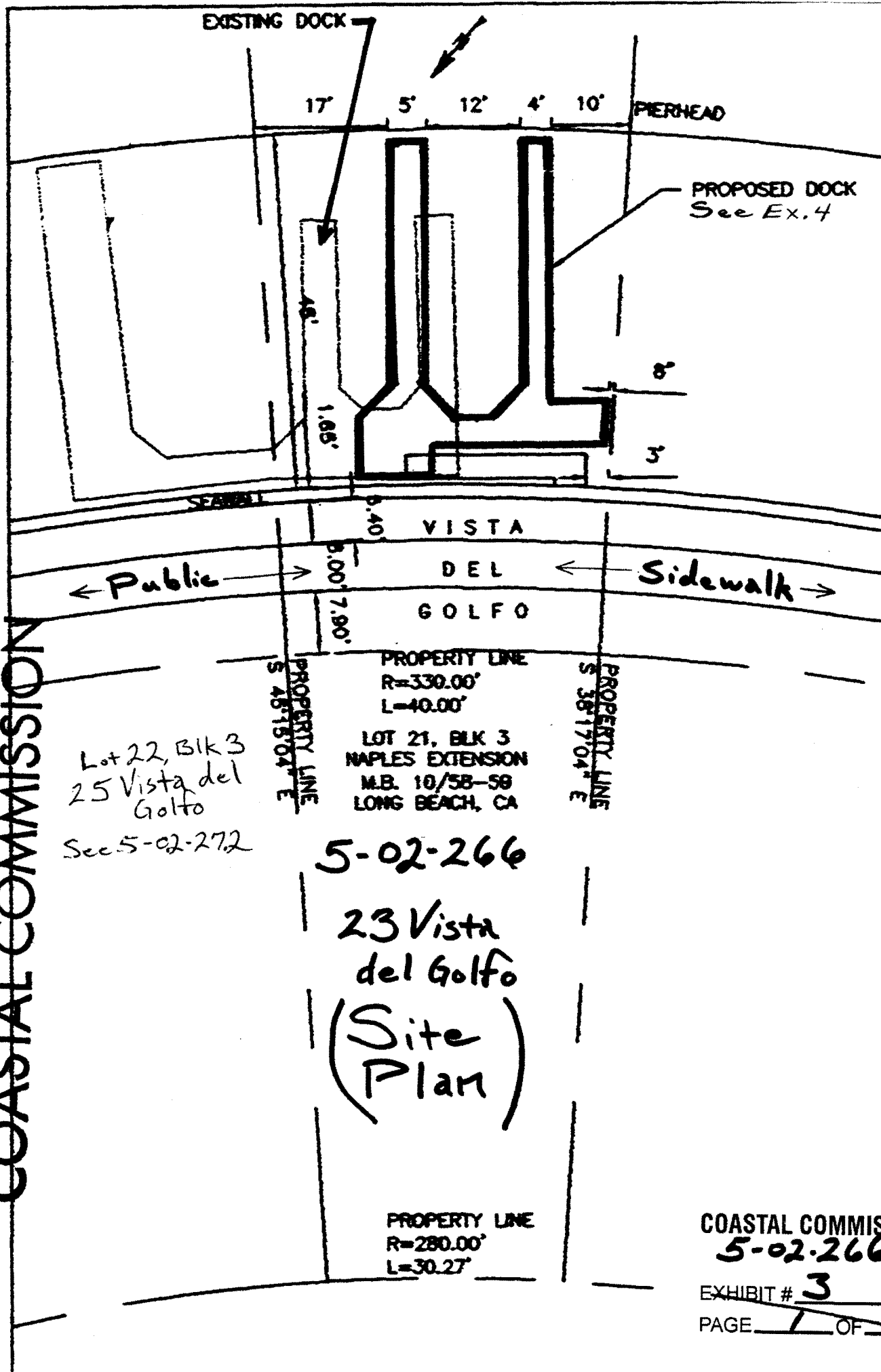

COASTAL COMMISSION

5-02-266

EXHIBIT # 3

PAGE 1 OF 1

PAGE 1 OF 1

PROTECT IN PLACE
EXIST. BULKHEAD

PILES ON 4'x5'
FINGER USE SAME
DIMENSIONS

6000 PSI CONC. W/8-1/2" STRANDS

PILE INSIDE 4'x4'
KNEE BRACKET.
6000 PSI CONC. W/8-1/2" STRANDS

M.L.L.W. = 0.00'v

4'x8'x17" 4'x6'x17" 4'x6'x17" 4'x6'x17" 4'x6'x17" 4'x6'x17"

-5.0

-9.5

-23.0

-27.0

DOCK ELEVATION

SCALE

BROW TO CONNECT
W/HINGE AS SHOWN

EXIST. 4'x4' LANDING

EXIST. BULKHEAD

MAX. SLOPE 2:1

2'x10' TAPERED
TO 5' EACH END

4'x8'x17" FLOAT

BROW ELEVATION

SCALE

5-02-266
California Coastal Commission
South Coast District Office
APPROVED
DOCK DETAILS



BLUEWATER
Design Group

Planning and Engineering Services
For Marine and Waterfront Resorts

2300 Via Cabrillo Marina, Suite 200
San Pedro, CA 90732
Tel 310 548 3132
Fax 310 548 1924

DESIGNED BY	PT
TRAINED BY	JH
NOTED BY	TB

EXHIBIT # 5
PAGE 1 OF 1

