

CALIFORNIA COASTAL COMMISSION

South Coast Area Office
200 Oceangate, Suite 1000
Long Beach, CA 90802-4302
(562) 590-5071

TH 4bPermit Application No. **5-06-206**

Date: September 21, 2006

Page 1 of 7

**ADMINISTRATIVE PERMIT****APPLICANTS:** Balboa Coves; Attn: Deborah Henry**AGENT:** Swift Slip Dock & Pier Builders, Inc.**PROJECT****DESCRIPTION:** Remove and replace an existing dock system "like-for-like" consisting of a 5' x 44' pier, a 3' x 24' gangway, 4' x 143' center walk, fourteen (14) 3' x 26' fingers, a 12' x 20' landing with 4' sides and 11' angle cuts and four (4) 12" diameter concrete piles.**PROJECT****LOCATION:** Balboa Coves (Docks #9-23 in Cove B); Newport Beach (Orange County)**EXECUTIVE DIRECTOR'S DETERMINATION:** The findings for this determination, and for any special conditions, appear on subsequent pages.

NOTE: P.R.C. Section 30624 provides that this permit shall not become effective until it is reported to the Commission at its next meeting. If one-third or more of the appointed membership of the Commission so request, the application will be removed from the administrative calendar and set for public hearing at a subsequent Commission meeting. Our office will notify you if such removal occurs.

This permit will be reported to the Commission at the following time and place:

Thursday, October 12, 2006**8:00 a.m.****Hyatt Regency Long Beach****200 S. Pine Avenue****Long Beach, CA 90802**

IMPORTANT - Before you may proceed with development, the following must occur:

Pursuant to 14 Cal. Admin. Code Sections 13150(b) and 13158, you must sign the enclosed duplicate copy acknowledging the permit's receipt and accepting its contents, including all conditions, and return it to our office. Following the Commission's meeting, and once we have received the signed acknowledgement and evidence of compliance with all special conditions, we will send you a Notice of Administrative Permit Effectiveness.

BEFORE YOU CAN OBTAIN ANY LOCAL PERMITS AND PROCEED WITH DEVELOPMENT, YOU MUST HAVE RECEIVED BOTH YOUR ADMINISTRATIVE PERMIT AND THE NOTICE OF PERMIT EFFECTIVENESS FROM THIS OFFICE.

PETER DOUGLAS
Executive Director

By: Fernie Sy
Title: Coastal Program Analyst II

STANDARD CONDITIONS:

1. Notice of Receipt and Acknowledgment. The permit is not valid and development shall not commence until a copy of the permit, signed by the permittee or authorized agent, acknowledging receipt of the permit and acceptance of the terms and conditions, is returned to the Commission office.
2. Expiration. If development has not commenced, the permit will expire two years from the date this permit is reported to the Commission. Development shall be pursued in a diligent manner and completed in a reasonable period of time. Application for extension of the permit must be made prior to the expiration date.
3. Interpretation. Any questions of intent or interpretation of any term or condition will be resolved by the Executive Director or the Commission.
4. Assignment. The permit may be assigned to any qualified person, provided assignee files with the Commission an affidavit accepting all terms and conditions of the permit.
5. Terms and Conditions Run with the Land. These terms and conditions shall be perpetual, and it is the intention of the Commission and the permittee to bind all future owners and possessors of the subject property to the terms and conditions.

SPECIAL CONDITIONS: See pages four to seven.

EXECUTIVE DIRECTOR'S DETERMINATION (continued):

The Executive Director hereby determines that the proposed development is a category of development, which, pursuant to PRC Section 30624, qualifies for approval by the Executive Director through the issuance of an Administrative Permit. Subject to Standard and Special Conditions as attached, said development is in conformity with the provisions of Chapter 3 of the Coastal Act of 1976 and will not have any significant impacts on the environment within the meaning of the California Environmental Quality Act. If located between the nearest public road and the sea, this development is in conformity with the public access and public recreation policies of Chapter 3.

FINDINGS FOR EXECUTIVE DIRECTOR'S DETERMINATION:

A. Project Location, Description and Previous Commission Action At Subject Site

The subject site is located within the private locked gate community of Balboa Coves (Docks #9-23 in Cove "B") in the City of Newport Beach (Exhibits #1-2). Single-family residences characterize the subject site and the surrounding area. The proposed project involves the following: remove and replace an existing dock system "like-for-like" consisting of a 5' x 44' pier, a 3' x 24' gangway, 4' x 143' center walk, fourteen (14) 3' x 26' fingers, a 12' x 20' landing (herringbone design) with 4' sides and 11' angle cuts and four (4) 12" diameter concrete piles (Exhibits #3). The dock materials will consist of Douglas Fir and Trex. The proposed docks extend into the Rivo Alto channel, but no more than 30-feet as allowed by the City of Newport Beach Harbor Resources Harbor Permit Policy and is consistent with past Commission actions in the area.

Coastal public access to the bay is available West of the project site at the Channel Place public park (Exhibit #2).

The dock project will be used for boating related purposes to serve single-family residential developments. The site has been surveyed by the City of Newport Beach Harbor Resources Division

for eelgrass and no eelgrass was discovered within 15-feet of the project area. The eelgrass survey took place on May 17, 2006 by the City of Newport Beach Harbor Resources Division and eelgrass surveys completed during the active growth phase of eelgrass (typically March through October) are valid for 60-days with the exception of surveys completed in August-October. A survey completed in August - October shall be valid until the resumption of active growth (i.e., March 1). The project is agendized for the October 2006 Coastal Commission Hearing and by this time the eelgrass survey would not continue to be valid since 60-days have passed since the survey was completed. Thus, an up-to-date eelgrass survey must be conducted. In addition, the site has not been surveyed for *Caulerpa taxifolia*, therefore a pre-construction *Caulerpa taxifolia* survey must be conducted. *Caulerpa taxifolia* surveys are valid for 90 days. Therefore, the Commission imposes Special Conditions No. 2 and No. 3, which identifies the procedures necessary to be completed prior to beginning any construction. Also, if any *Caulerpa taxifolia* is found on the project site, Special Conditions No. 3 also identifies the procedures necessary to be completed prior to beginning any construction.

The proposed project has received an approval in concept from the City of Newport Beach Harbor Resources Division. The Regional Water Quality Control Board (RWQCB) has determined that the proposed project will not adversely impact water quality if standard construction methods and materials are used. The applicant has applied for a permit from the U.S. Army Corps of Engineers.

Section 30600(c) of the Coastal Act provides for the issuance of coastal development permits directly by the Commission in regions where the local government having jurisdiction does not have a certified Local Coastal Program. The City of Newport Beach only has a certified Land Use Plan and has not exercised the options provided in 30600(b) or 30600.5 to issue its own permits. Therefore, the Coastal Commission is the permit issuing entity and the standard of review is Chapter 3 of the Coastal Act. The certified Land Use Plan may be used for guidance.

B. Marine Resources

The proposed recreational boat dock development and its associated structures are an allowable and encouraged marine related use. The project design includes the minimum sized pilings and the minimum number of pilings necessary for structural stability. There are no feasible less environmentally damaging alternatives available. As conditioned, the project will not significantly adversely impact eelgrass beds and will not contribute to the dispersal of the invasive aquatic algae, *Caulerpa taxifolia*. Further, as proposed and conditioned, the project, which is to be used solely for recreational boating purposes, conforms to Sections 30224 and 30233 of the Coastal Act.

C. Water Quality

The proposed work will be occurring on, within, or adjacent to coastal waters. The storage or placement of construction material, debris, or waste in a location where it could be discharged into coastal waters would result in an adverse effect on the marine environment. To reduce the potential for construction related impacts on water quality, the Commission imposes special conditions requiring, but not limited to, the appropriate storage and handling of construction equipment and materials to minimize the potential of pollutants to enter coastal waters. To reduce the potential for post-construction impacts to water quality the Commission requires the continued use and maintenance of post construction BMPs. As conditioned, the Commission finds that the development conforms to Sections 30230 and 30231 of the Coastal Act.

D. Local Coastal Program

The LUP for the City of Newport Beach was effectively certified on May 19, 1982. At the October 2005 Coastal Commission Hearing, the certified LUP was updated. As conditioned, the proposed development is consistent with Chapter 3 of the Coastal Act and with the certified Land Use Plan for the area. Approval of the project, as conditioned, will not prejudice the ability of the local government to prepare a Local Coastal Program that is in conformity with the provisions of Chapter 3.

E. California Environmental Quality Act (CEQA)

As conditioned, there are no feasible alternatives or additional feasible mitigation measures available that would substantially lessen any significant adverse effect that the activity may have on the environment. Therefore, the Commission finds that the proposed project, as conditioned to mitigate the identified impacts, is the least environmentally damaging feasible alternative and can be found consistent with the requirements of the Coastal Act to conform to CEQA.

SPECIAL CONDITIONS:

1. Water Quality

A. Construction Responsibilities and Debris Removal

- (1) No construction materials, equipment, debris, or waste will be placed or stored where it may be subject to wave, wind, or rain erosion and dispersion.
- (2) Any and all construction material will be removed from the site within 10 days of completion of construction.
- (3) Machinery or construction materials not essential for project improvements will not be allowed at any time in the intertidal zone.
- (4) If turbid conditions are generated during construction a silt curtain will be utilized to control turbidity.
- (5) Floating booms will be used to contain debris discharged into coastal waters and any debris discharged will be removed as soon as possible but no later than the end of each day.
- (6) Non-buoyant debris discharged into coastal waters will be recovered by divers as soon as possible after loss.

B. Best Management Practices Program

By acceptance of this permit the applicants agree that the long-term water-borne berthing of boat(s) in the approved dock and/or boat slip will be managed in a manner that protects water quality pursuant to the implementation of the following BMPs.

- (1) Boat Cleaning and Maintenance Measures:
 - a. In-water top-side and bottom-side boat cleaning shall minimize the discharge of soaps, paints, and debris.
 - b. In-the-water hull scraping or any process that occurs under water that results in the removal of paint from boat hulls shall be prohibited. Only detergents and

cleaning components that are designated by the manufacturer as phosphate-free and biodegradable shall be used, and the amounts used minimized.

- c. The applicants shall minimize the use of detergents and boat cleaning and maintenance products containing ammonia, sodium hypochlorite, chlorinated solvents, petroleum distillates or lye.

(2) Solid and Liquid Waste Management Measures:

- a. All trash, recyclables, and hazardous wastes or potential water contaminants, including old gasoline or gasoline with water, absorbent materials, oily rags, lead acid batteries, anti-freeze, waste diesel, kerosene and mineral spirits will be disposed of in a proper manner and will not at any time be disposed of in the water or gutter.

(3) Petroleum Control Management Measures:

- a. Oil absorbent materials shall be examined at least once a year and replaced as necessary. The applicants will recycle the materials, if possible, or dispose of them in accordance with hazardous waste disposal regulations. The boaters will regularly inspect and maintain engines, seals, gaskets, lines and hoses in order to prevent oil and fuel spills. Boaters will use preventive engine maintenance, oil absorbents, bilge pump-out services, or steam cleaning services as much as possible to clean oily bilge areas. Bilges shall be cleaned and maintained. Detergents will not be used for cleaning. The use of soaps that can be discharged by bilge pumps is prohibited.

2. Eelgrass Survey(s)

- A. Pre Construction Eelgrass Survey.** A valid pre-construction eelgrass (*Zostera marina*) survey shall be completed during the period of active growth of eelgrass (typically March through October). The pre-construction survey shall be completed prior to the beginning of construction and shall be valid until the next period of active growth. The survey shall be prepared in full compliance with the "Southern California Eelgrass Mitigation Policy" Revision 8 (except as modified by this special condition) adopted by the National Marine Fisheries Service and shall be prepared in consultation with the California Department of Fish and Game. The applicants shall submit the eelgrass survey for the review and approval of the Executive Director within five (5) business days of completion of each eelgrass survey and in any event no later than fifteen (15) business days prior to commencement of any development. If the eelgrass survey identifies any eelgrass within the project area which would be impacted by the proposed project, the development shall require an amendment to this permit from the Coastal Commission or a new coastal development permit.
- B. Post Construction Eelgrass Survey.** If any eelgrass is identified in the project area by the survey required in subsection A of this condition above, within one month after the conclusion of construction, the applicants shall survey the project site to determine if any eelgrass was adversely impacted. The survey shall be prepared in full compliance with the "Southern California Eelgrass Mitigation Policy" Revision 8 (except as modified by this special condition) adopted by the National Marine Fisheries Service and shall be prepared in consultation with the California Department of Fish and Game. The applicants shall submit the post-construction eelgrass survey for the review and approval of the Executive Director within thirty-(30) days after completion of the survey.

If any eelgrass has been impacted, the applicants shall replace the impacted eelgrass at a minimum 1.2:1 ratio on-site, or at another location, in accordance with the Southern California Eelgrass Mitigation Policy. All impacts to eelgrass habitat shall be mitigated at a minimum ratio of 1.2:1 (mitigation:impact). The exceptions to the required 1.2:1 mitigation ratio found within SCEMP shall not apply. Implementation of mitigation shall require an amendment to this permit or a new coastal development permit unless the Executive Director determines that no amendment or new permit is required.

3. Pre-construction *Caulerpa Taxifolia* Survey

- A.** Not earlier than 90 days nor later than 30 days prior to commencement or re-commencement of any development authorized under this coastal development permit (the “project”), the applicants shall undertake a survey of the project area and a buffer area at least 10 meters beyond the project area to determine the presence of the invasive alga *Caulerpa taxifolia*. The survey shall include a visual examination of the substrate.
- B.** The survey protocol shall be prepared in consultation with the Regional Water Quality Control Board, the California Department of Fish and Game, and the National Marine Fisheries Service.
- C.** Within five (5) business days of completion of the survey, the applicants shall submit the survey:
 - (1) for the review and approval of the Executive Director; and
 - (2) to the Surveillance Subcommittee of the Southern California Caulerpa Action Team (SCCAT). The SCCAT Surveillance Subcommittee may be contacted through William Paznokas, California Department of Fish & Game (858/467-4218) or Robert Hoffman, National Marine Fisheries Service (562/980-4043).
- D.** If *Caulerpa taxifolia* is found within the project or buffer areas, the applicants shall not proceed with the project until 1) the applicants provide evidence to the Executive Director that all *C. taxifolia* discovered within the project and buffer area has been eliminated in a manner that complies with all applicable governmental approval requirements, including but not limited to those of the California Coastal Act, or 2) the applicants have revised the project to avoid any contact with *C. taxifolia*. No revisions to the project shall occur without a Coastal Commission approved amendment to this coastal development permit unless the Executive Director determines that no amendment is legally required.

ACKNOWLEDGMENT OF PERMIT RECEIPT/ACCEPTANCE OF CONTENTS:

I/We acknowledge that I/we have received a copy of this permit and have accepted its contents including all conditions.

Applicant's Signature

Date of Signing

H:\FSY\Staff Reports\Oct06\5-06-206-[Balboa Coves]AP(NB)

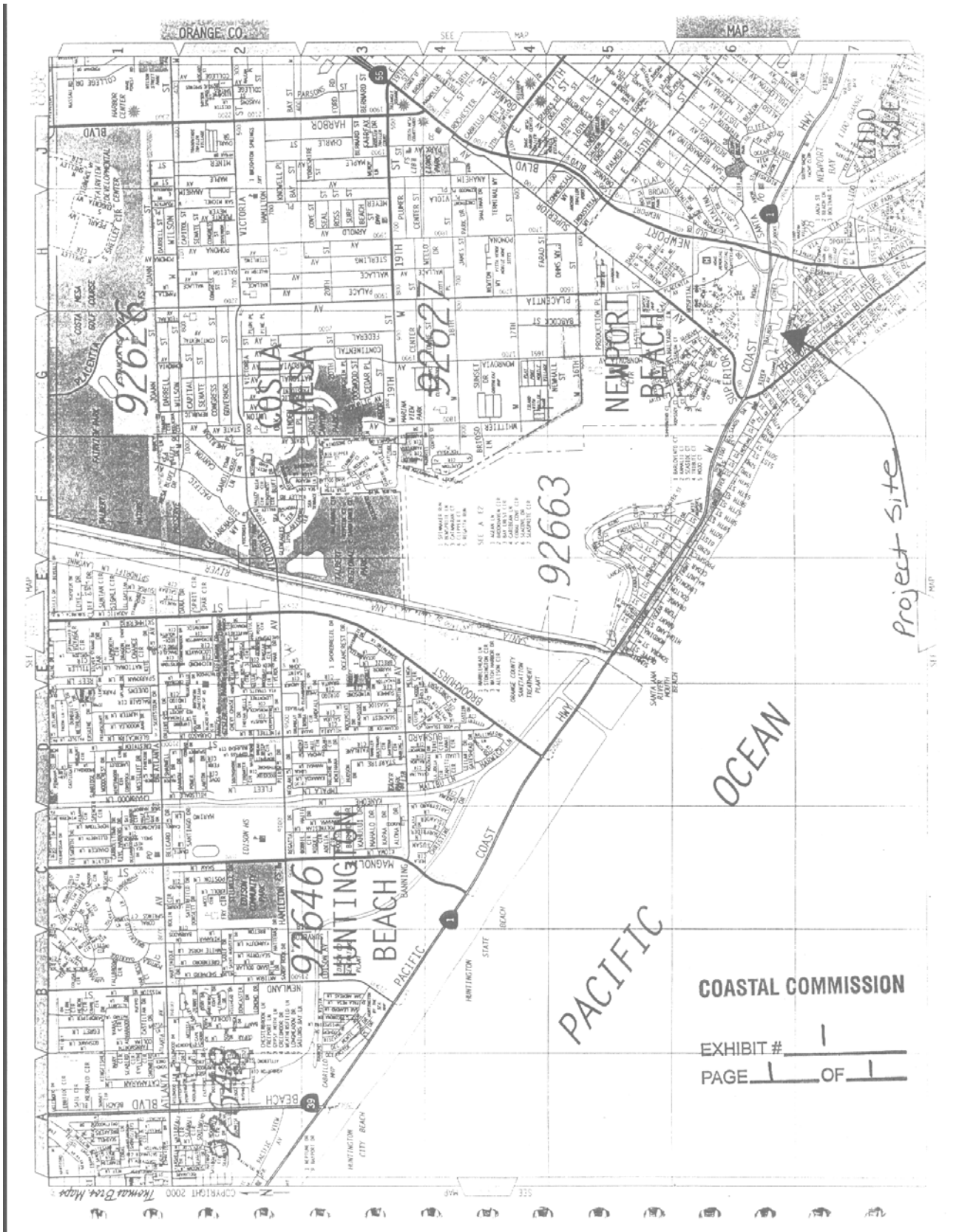

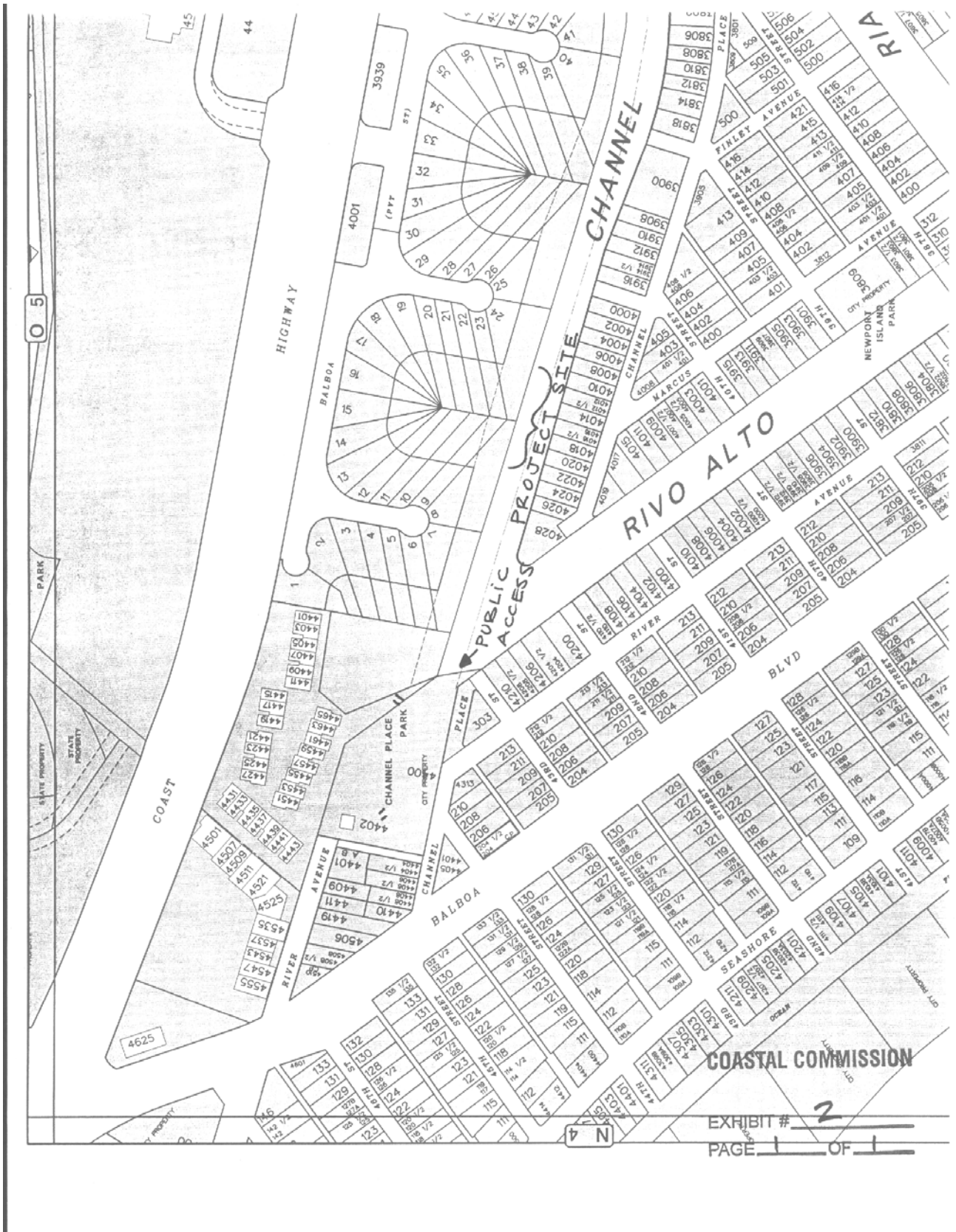

1 of 2

CITY OF NEWPORT BEACH

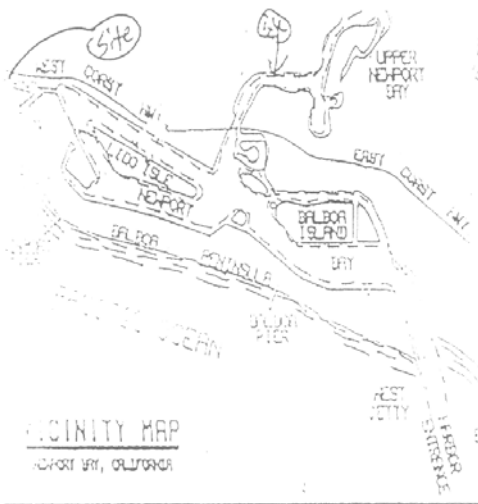

RECEIVED
 South Coast Region

JUN 1 2006

CALIFORNIA
 COASTAL COMMISSION

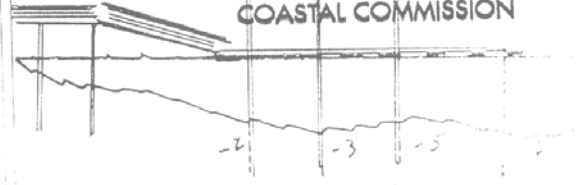

PROFILE 1' =

SOUNDINGS ARE EXPRESSED IN FEET AND
 ELEVATIONS BASED ON MEAN LOW WATER

SCOPE OF WORK:
 Remove entire dock
 system. Install
 new dock, gangway
 & pier same size
 & configuration as
 existing. Replace
 4-12" pile same
 location as existing

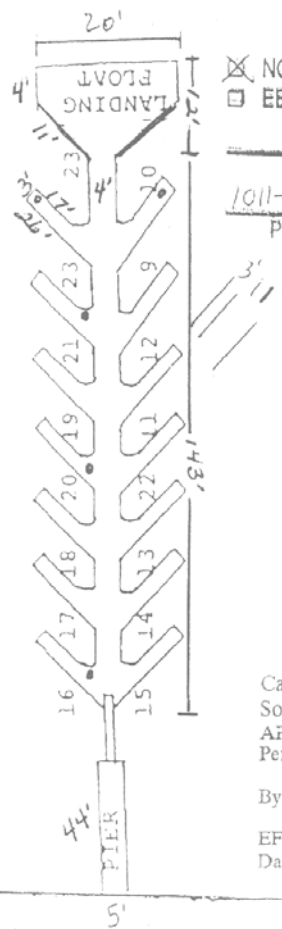

EEL GRASS INSPECTION
 NO EEL GRASS WITHIN 15' OF PROJECT
 EEL GRASS IN THE PROJECT AREA
 Chris Miller
 SIGNATURE
 1011-097 5/17/06
 PERMIT # DATE

HARBOR RESOURCES
 CITY OF NEWPORT BEACH
 Chris Miller, State

COASTAL COMMISSION

EXHIBIT # 3
 PAGE 1 OF 1

California Coastal Commission
 South Coast District Office
 APPROVED Permit No. 5-06-206

By: _____
 EFFECTIVE
 Date: _____

PLAN 11.51

PROJECT'S NAME BALBOA COVES JOB ADDRESS Cove "B" ADDRESS 9-23