

CALIFORNIA COASTAL COMMISSION

South Coast Area Office
200 Oceangate, Suite 1000
Long Beach, CA 90802-4302
(562) 590-5071



F7b

5-17-0130(FREDERIKSEN)

MAY 12, 2017

EXHIBITS

Table of Contents

Exhibit 1 – Location/Vicinity Map

Exhibit 2 – Proposed and Existing Dock Configurations

Subject site: *312 Evening Star Ln dock



North
Star
Beach

Newport
Beach
GIS



0 100 200
Feet

Disclaimer: Every reasonable effort has been made to assure the accuracy of the data provided, however, The City of Newport Beach and its employees and agents disclaim any and all responsibility from or relating to any results obtained in its use.

COASTAL COMMISSION

Imagery: 2009-2013 photos provided by Eagle Imaging www.eagleaerial.com

EXHIBIT # 1

PAGE 1 **OF** 2

1/16/2017



Newport
Beach
GIS



0 20 40
Feet

Disclaimer: Every reasonable effort has been made to assure the accuracy of the data provided, however, The City of Newport Beach and its employees and agents disclaim any and all responsibility from or relating to any results obtained in its use.

Imagery: 2009-2013 photos provided by Eagle Imaging www.eagleaerial.com

COASTAL COMMISSION

EXHIBIT # 1

PAGE 2 OF 2

* Proposed Dock Configuration

CITY OF NEWPORT BEACH

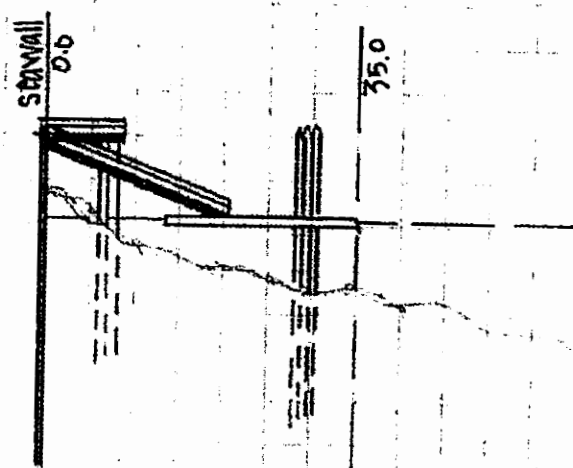
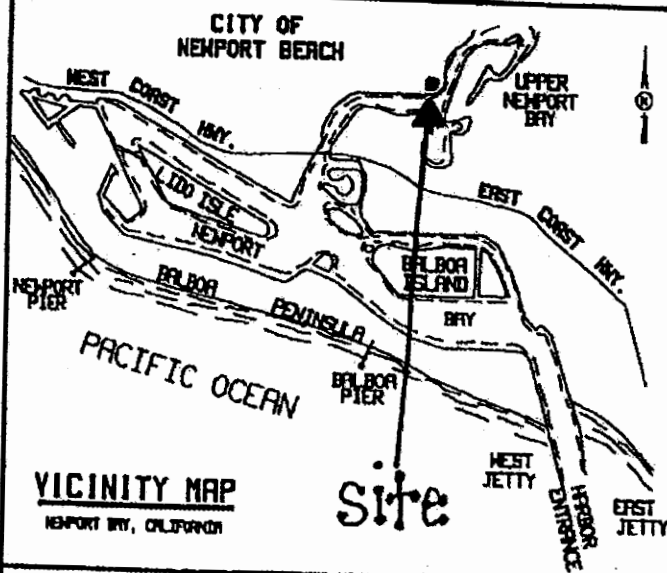

SOUNDINGS ARE EXPRESSED IN FEET AND DENOTE ELEVATIONS BASED ON MEAN LOWER LOW WATER.

SCOPE OF WORK:

Remove existing 676 sq. ft. U shaped floating dock and 72 sq. ft. gangway.
Replace with new 636 sq. ft. L shaped floating dock, 72 square foot gangway, and add 1 x 4 section to existing 8 x 8 pier.
DECREASE OF 36 SQ. FT.

HARBOR RESOURCES DIV.
CITY OF NEWPORT BEACH

Swalsh 1/19/17

COASTAL COMMISSION

EXHIBIT # 2
PAGE 1 OF 2

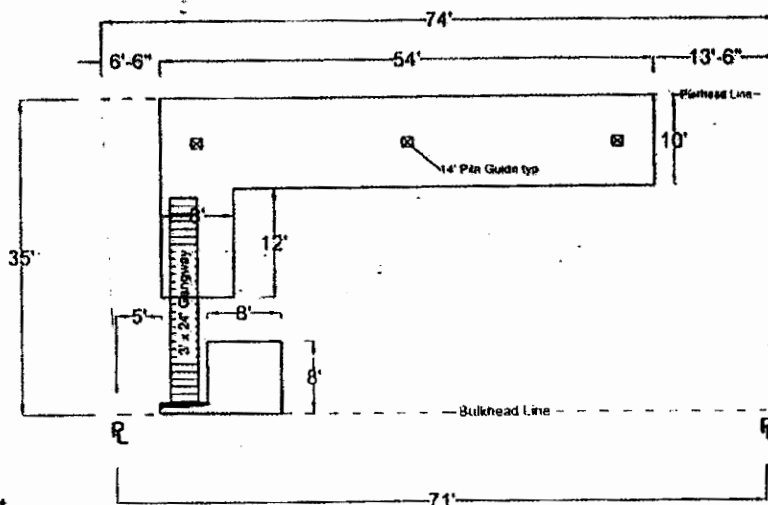

EEL GRASS INSPECTION

- ☐ Eelgrass within 15' of project
- ☐ Eelgrass within 15 - 30' of project
- ☒ No Eelgrass in project area

Swalsh

Signature

10/31/16 1145

Inspection Date & Time

Floating Dock: 636 sq ft

54 x 10 = 540

8 x 12 = 96

Pier: 64 sq ft

8 x 8 = 64 sq ft

1 x 4 = 4 sq ft

Gangway:
3 x 24 = 72

Total: 776 sq ft

APPLICANT'S NAME TORBIN FREDERICKSON

JOB ADDRESS 312 EVENING STAR LANE

DATE 1-16-2017

31' 13' 5' 28' 33' 5' 2' 10' 35'

Pierhead Line Bulkhead Line

4'x4' knee

24' x 3' gangway

EXHIBIT # 2

PAGE 2 OF 2

COASTAL COMMISSION

RECEIVED

EXHIBIT # 2
PAGE 2 OF 2

COASTAL COMMISSION

The information contained in this drawing is confidential and proprietary to Swift Slip Dock & Pier Builders, Inc. No part of this drawing may be distributed, disclosed or reproduced in any form to any third party without consent from Swift Slip Dock & Pier Builders, Inc.

AMENDMENTS.