

## **CALIFORNIA COASTAL COMMISSION**

45 FREMONT STREET, SUITE 2000  
SAN FRANCISCO, CA 94105-2219  
VOICE (415) 904-5200  
FAX (415) 904-5400  
TDD (415) 597-5885



# **W 8a**

**5-16-1142 (LAYTON)**

**MAY 19, 2017**

## **EXHIBITS**

**Table of Contents**

**Exhibit 1: Project Plan**

**Exhibit 2: Site Map and Plan**

P.

# Exhibit 1



Swift Slip Dock & Pier Builders, Inc

642 Baker St, Costa Mesa, CA, 92626

Phone: (949) 631-3121

Fax: (714) 509-0618

CLIENT: Layton	EN DRAWN.	PS CHECKED.	REVISION.	9/2/16 DATE.	AMENDMENTS:			
SITE: 306 The Rialto, Newport Beach					REV:	DESCRIPTION:	BY:	DATE:

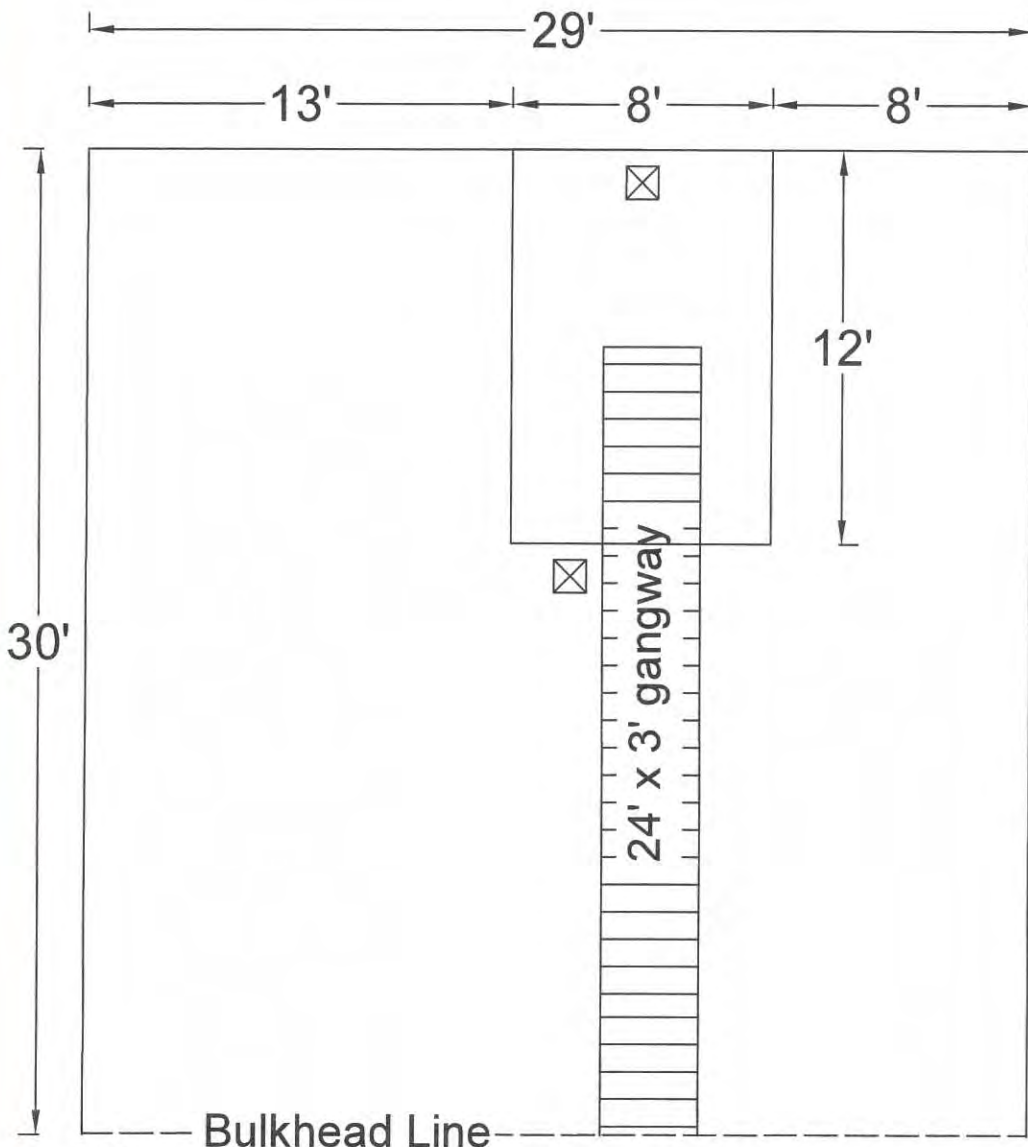

Typical Pile: 12" x 12"



Floating Dock: 96 sq ft

8 x 12 = 96

Gangway:

24 x 3 = 72

Total Area: 168 sq ft

ER

ER

RECEIVED  
South Coast Region

5-16-1142

DEC 23 2016

The information contained in this drawing is confidential and proprietary to Swift Slip Dock & Pier Builders, Inc. No part of this drawing may be distributed, disclosed or reproduced in any form to any third party without consent from Swift Slip Dock & Pier Builders, Inc.

# CITY OF NEWPORT BEACH

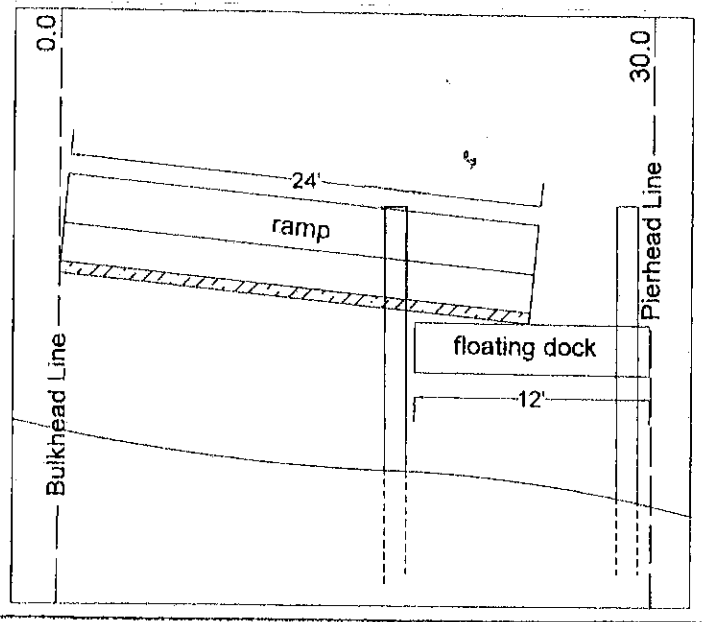
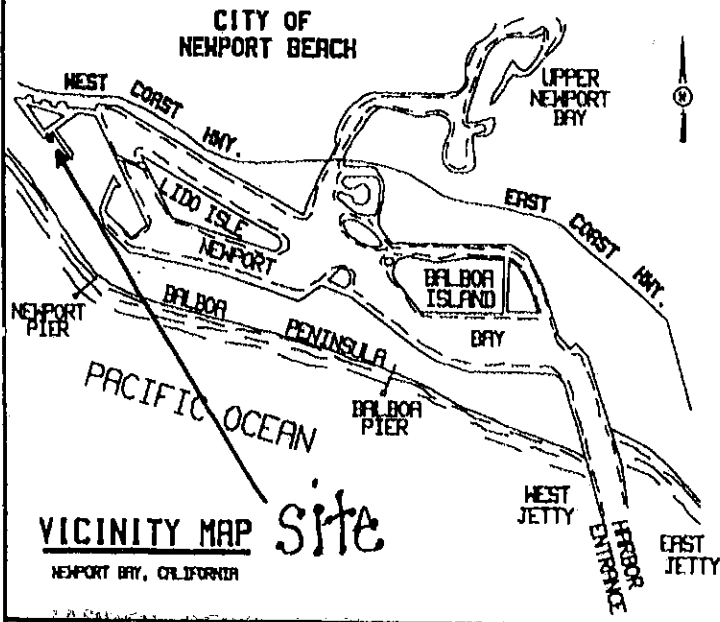

SOUNDINGS ARE EXPRESSED IN FEET AND DENOTE ELEVATIONS BASED ON MEAN LOWER LOW WATER.

HARBOR RESOURCES DIV.  
CITY OF NEWPORT BEACH  
*J. Walter 11/29/16*

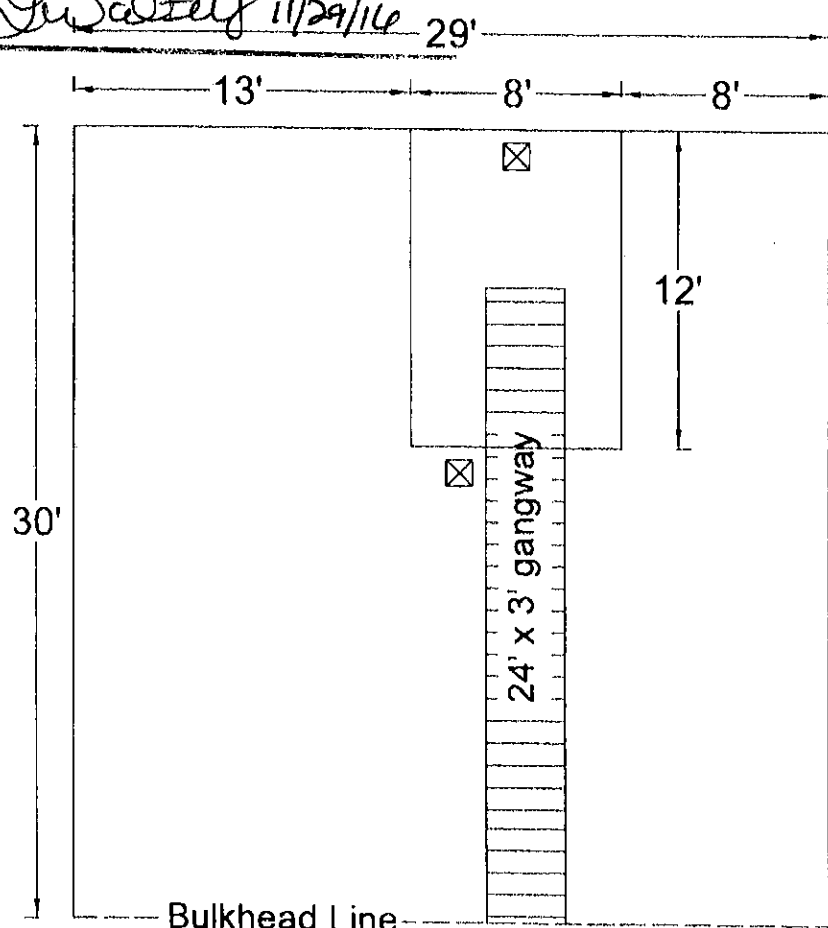

**SCOPE OF WORK:**  
Remove existing 15 x 10 floating dock, 20 x 3 gangway, and (2) 12" marina guide pile. Replace with new 12 x 8 floating dock, 24 x 3 gangway, and (2) 12" marina guide pile.

**RECEIVED**  
South Coast Region  
DEC 2 9 2016

Typical Pile: 12" x 12"



Floating Dock: 96 sq ft

8 x 12 = 96

Gangway:

24 x 3 = 72

Total Area: 168 sq ft

**EEL GRASS INSPECTION**

- Eelgrass within 15' of project
- Eelgrass within 15 - 30' of project
- No Eelgrass in project area

*J. Walter*  
Signature

10/6/16 11:5-11:35  
Inspection Date & Time

ER

ER

APPLICANT'S NAME **STEVE LAYTON**

JOB ADDRESS **306 THE RIDGE**

DATE **9.12.2016**

5-16-114 CALIFORNIA COASTAL COMMISSION