

**CALIFORNIA COASTAL COMMISSION**

South Coast District Office  
301 E Ocean Blvd., Suite 300  
Long Beach, CA 90802-4302  
(562) 590-5071



# W9c

**5-20-0445 (JT & LT NB, LLC)**

**DECEMBER 15, 2021**

## **EXHIBITS**

### **Table of Contents**

**EXHIBIT NO. 1 – LOCATION MAP .....2**

**EXHIBIT NO. 2 – SITE PLAN.....3**

**EXHIBIT NO. 3 – BULKHEAD SITE PLAN AND ELEVATION .....4**

**EXHIBIT NO. 4 – SECTION PLAN.....5**

**EXHIBIT NO. 5 – GRADING PLAN.....6**

## Exhibit No. 1 – Location Map

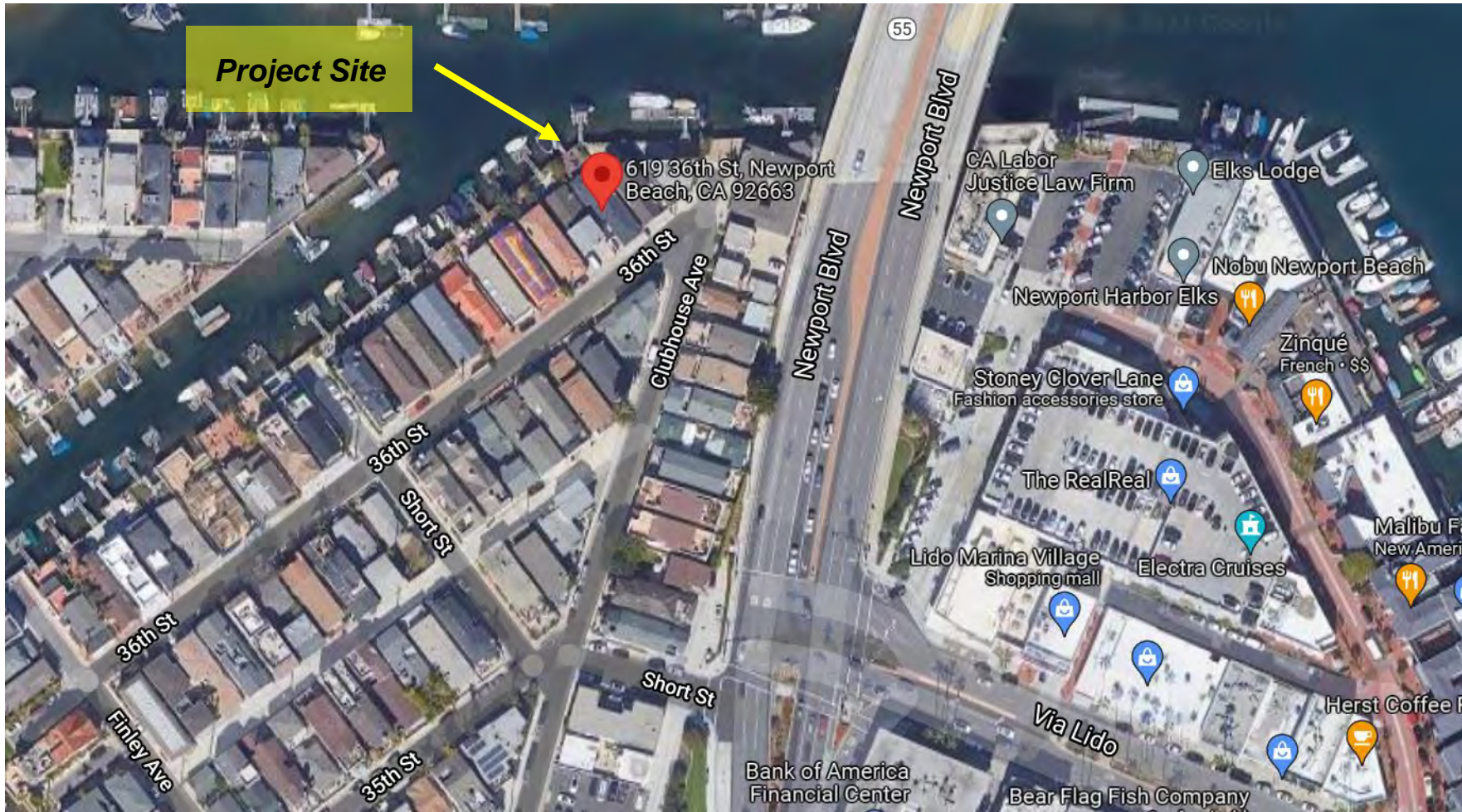

# Exhibit No. 2 – Site Plan

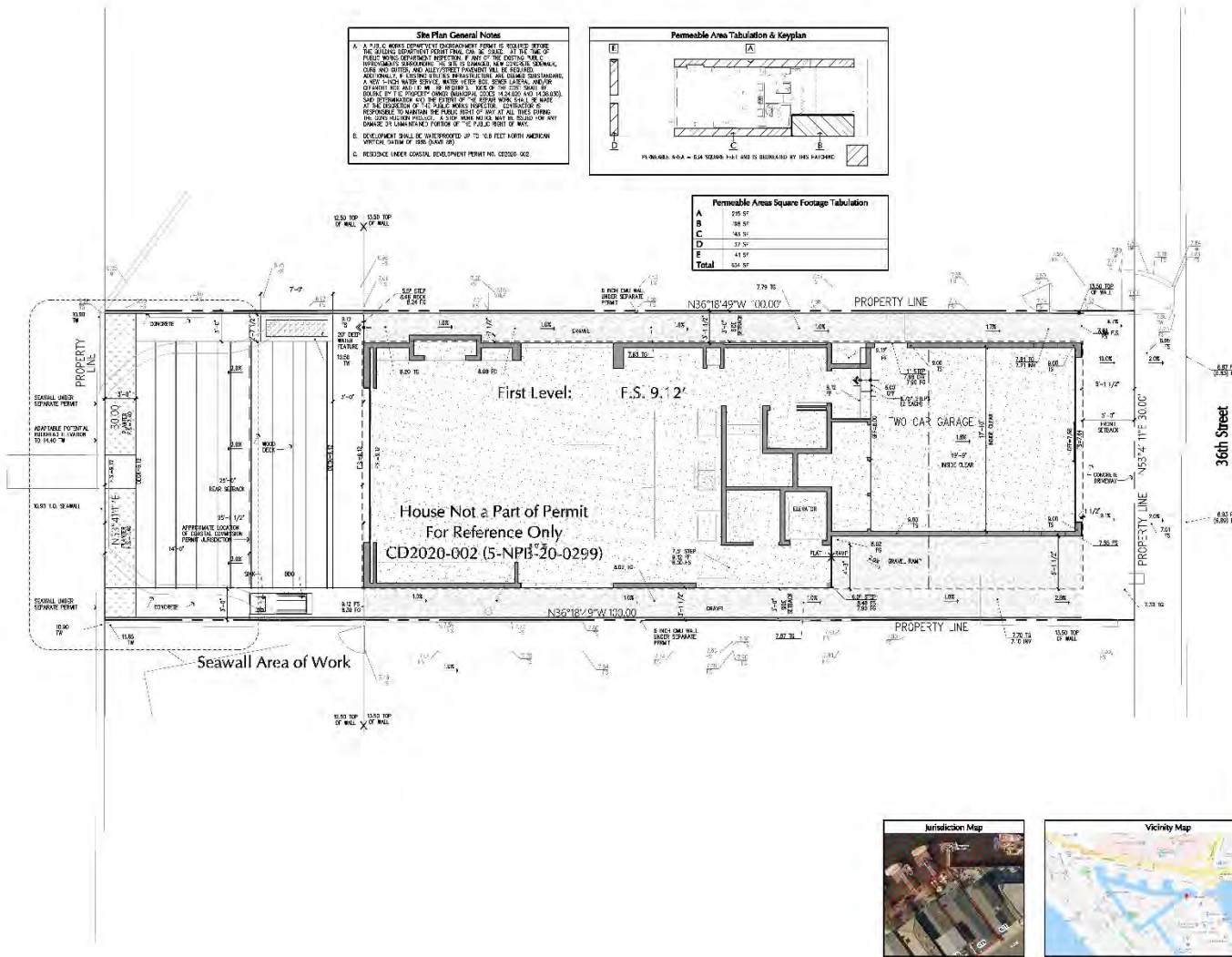

**Site Plan General Notes**

A. A PUBLIC WORKS CONSTRUCTION PERMIT IS REQUIRED BEFORE THE SEAWALL CONSTRUCTION SHALL BE STARTED. THE PUBLIC WORKS DEPARTMENT REPRESENTATIVE OF THE DISTRICT PUBLIC WORKS DEPARTMENT SHALL BE CONTACTED FOR PERMIT INFORMATION. PERMITS SHALL BE OBTAINED FROM THE DISTRICT PUBLIC WORKS DEPARTMENT REPRESENTATIVE. PERMITS SHALL BE OBTAINED FROM THE DISTRICT PUBLIC WORKS DEPARTMENT REPRESENTATIVE. PERMITS SHALL BE OBTAINED FROM THE DISTRICT PUBLIC WORKS DEPARTMENT REPRESENTATIVE.

B. DEVELOPMENT SHALL BE SUBMITTED UP TO 100 FEET NORTH AMERICAN DATUM (NAD 83) TO THE DISTRICT PUBLIC WORKS DEPARTMENT REPRESENTATIVE.

C. PERMITS SHALL BE OBTAINED FROM THE DISTRICT PUBLIC WORKS DEPARTMENT REPRESENTATIVE.

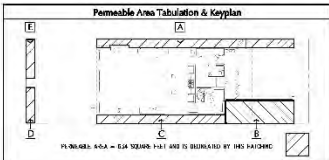

**Permeable Area Square Footage Tabulation**

A	218 SF
B	188 SF
C	143 SF
D	37 SF
E	44 SF
<b>Total</b>	<b>620 SF</b>

**C.J. LIGHT ASSOCIATES**

Oliver R. Light - A-5118101

1611 Quail Drive, Suite 123  
 Newport Beach, CA 92660  
 (949) 451-4500  
 OLIVER@CJLA.COM

**Custom Residence**  
 619 36th Street  
 Newport Beach • California • 92663

**Seawall Site Plan**

Job Number: 4008  
 Scale: 1/8" = 1'-0"  
 Date:  
 E. J. Jorg Sept 1 06/2020  
 E. J. Jorg Sept 2 2020/2105  
 E. J. Jorg Sept 3 06/20/2101



SW 1





# Exhibit No. 5 – Grading Plan

