

**CALIFORNIA COASTAL COMMISSION**

South Coast Area Office  
301 East Ocean Blvd., Suite 300  
Long Beach, CA 90802  
(562) 590-5071



**W7a**

**5-21-0040 (Wasson)  
JUNE 9, 2021**

**EXHIBITS**

**Exhibit 1: Vicinity Map and Project Site**

**Exhibit 2: Project Plans**

**Exhibit 3: Letter from Engineering Consultant**

**Exhibit 4: City of Huntington Beach Public Works Dept. 5/13/2021 Letter**



5-21-044 Wasson

3841 Seascape Drive, Huntington Beach, Orange County

Boat Dock Replacement & Addition

Exhibit 1a



**5-21-0044 Wasson  
Exhibit 1b**





**5-21-0044 Wasson  
Exhibit 1c**

5-21-0044 Wasson  
Proposed Boat Dock  
Exhibit 2a

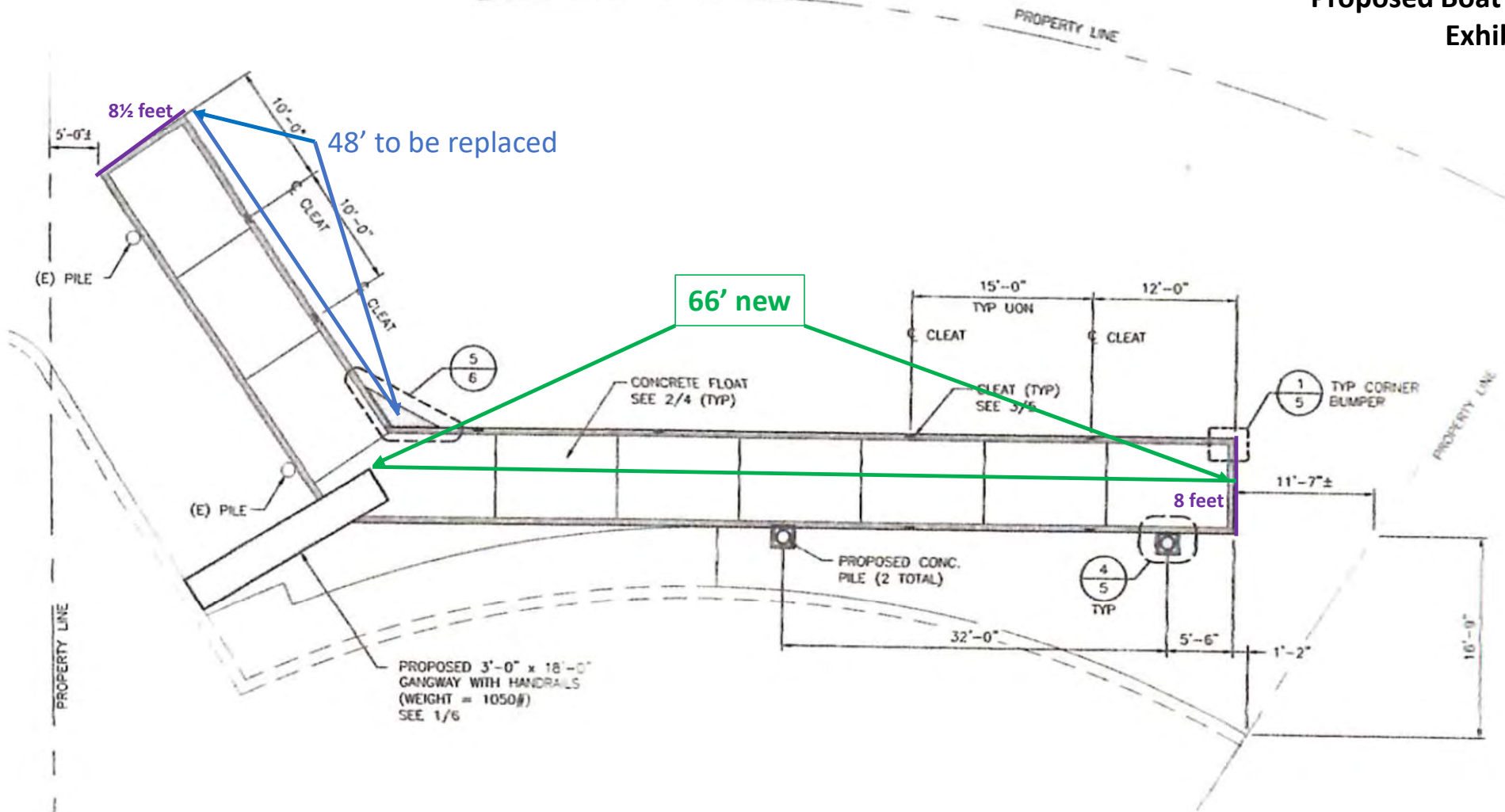

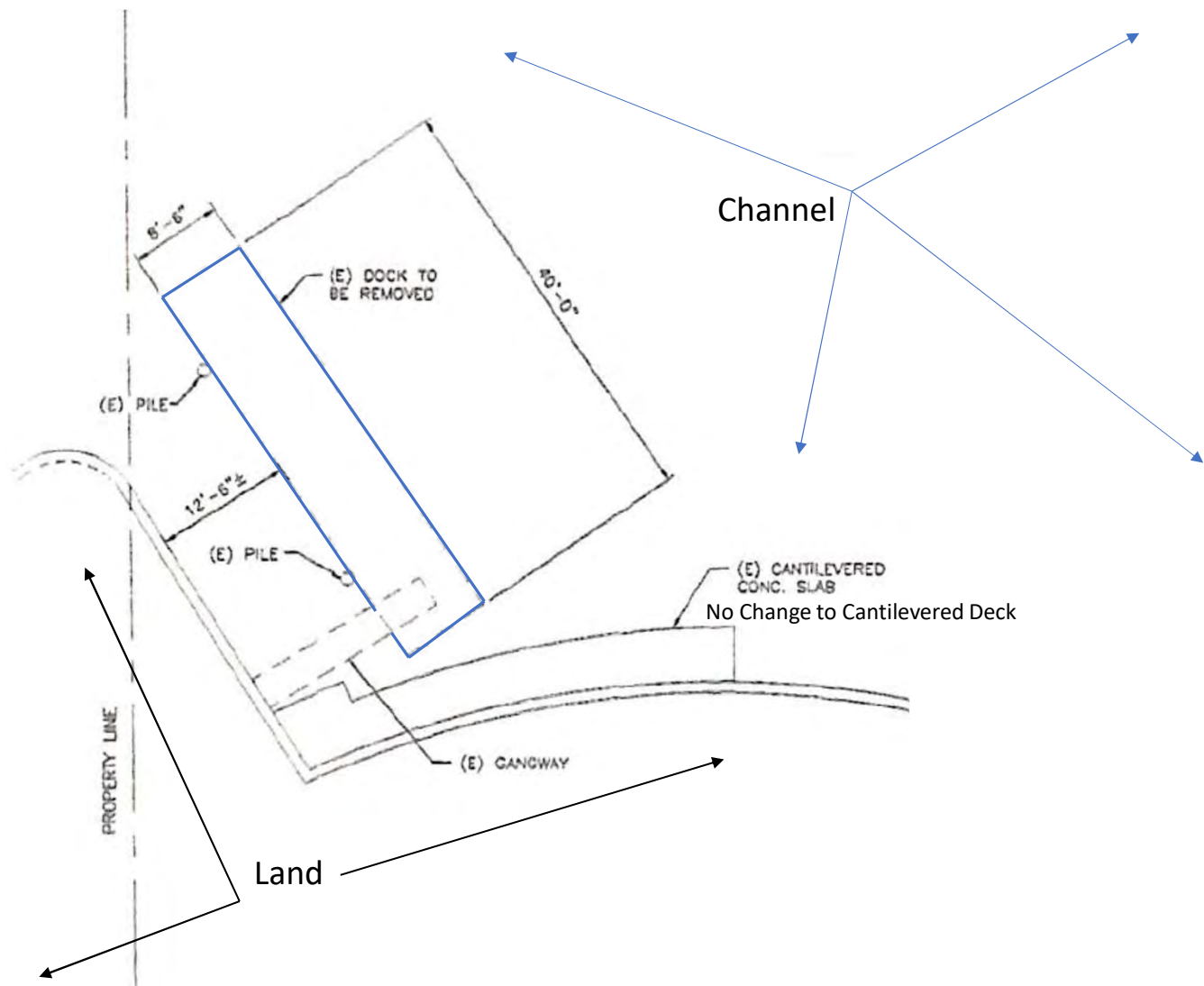

**5-21-0044 Wasson  
Existing Boat Dock  
(to be removed, replaced  
& expanded)  
Exhibit 2b**





April 7, 2021

CPS Coastal Permit Specialist  
4010 Channel Place  
Newport Beach, CA 92663

Attention: Ms. Jacquelyn Chung

Subject: Dock Replacement for:  
Ellis Wasson  
3841 Seascape Drive  
Huntington Beach, CA

Dear Ms. Chung,

This letter is to address the request to reduce the width of the proposed 8'-6" wide dock system. The dock is composed of a 35'-0" long section joined to a 75'-0" long section at a 125-degree angle. This system does not utilize "fingers" or dock sections perpendicular to the mainwalk. Therefore, it is inherently unstable. The most effective method to increase stability is to increase the width to meet the marina design standards for rolling / tilting under a concentrated edge load. The depth, as designed, provides the lateral stiffness to withstand edge loading, wind and berthing impact loads for the large vessel supported by this system.

A reduction in width would decrease the rotational stability of the system for live loads and the discomfort will reduce the confidence of the worthiness of the dock system. A decrease in width would also reduce the lateral stiffness of the system and reduce its usable life due to the increased stresses of wind loads on a docked vessel and impact loads during berthing.

From an engineering point of view, it is my recommendation that the width of the system remain as originally designed.

Sincerely,

A handwritten signature in blue ink, appearing to read "Scott Betancourt", written over a light blue horizontal line.

Scott Betancourt, S.E.





# CITY OF HUNTINGTON BEACH

## Public Works Department

Sean Crumby, PE  
Director of Public Works

May 13, 2021

Meg Vaughn  
California Coastal Commission  
301 East Ocean Boulevard, Suite 300  
Long Beach, CA 90802

Dear Ms. Vaughn:

**Subject: Environmental Project for 3841 Seascapes Drive, Huntington Beach – Wasson Residence**

The City of Huntington Beach has agreed to partner with the Wasson family to fund the replacement of signage for the marine vessel sewage pump-out station. These signs which are located in Huntington Harbor at the public dock at 3841 Warner Avenue are designed to instruct users on how to use the pump-out station to properly dispose of waste water and sewage from marine vessels.

This pump-out station is critical in protecting the water quality by providing an easily accessible sewage pump-out station that is free to the public. Providing this service minimizes the potential for illegal discharges of sewage and other waste water from marine vessels into the waters of Huntington Harbor.

These signs have deteriorated and need to be replaced and the funding from the Wasson's will be allocated to replace these location and instructional signs.

Thank you and please feel free to contact me at (714) 374-1548 or [JMerid@surfcity-hb.org](mailto:JMerid@surfcity-hb.org).

Sincerely,

Jim Merid  
Environmental Services Manager





★ Location: 3841 Warner Avenue, Huntington Beach



Marine Vessel Sewage Pump-out Signage 1



**Marine Vessel Sewage Pump-out Signage**



**Marine Vessel Sewage Pump-out Signage 3**