

CALIFORNIA COASTAL COMMISSION

South Coast District Office
301 E Ocean Blvd., Suite 300
Long Beach, CA 90802-4302
(562) 590-5071



W7a

5-22-0612 (JOHN DEVIR)

NOVEMBER 29, 2022

EXHIBITS

Exhibit 1—Vicinity Map	2
Exhibit 2 – Project Plans	3

Exhibit 1—Vicinity Map

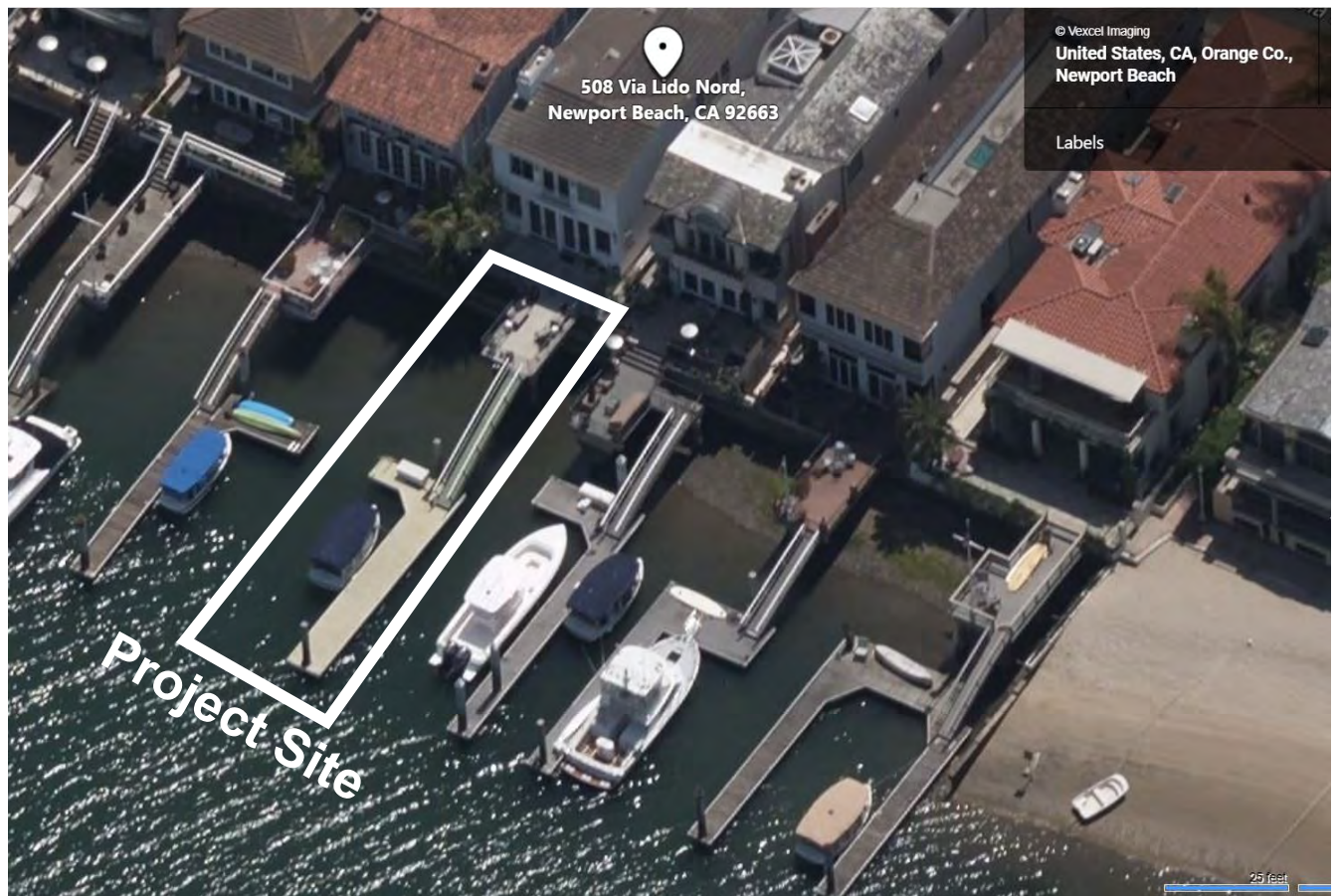
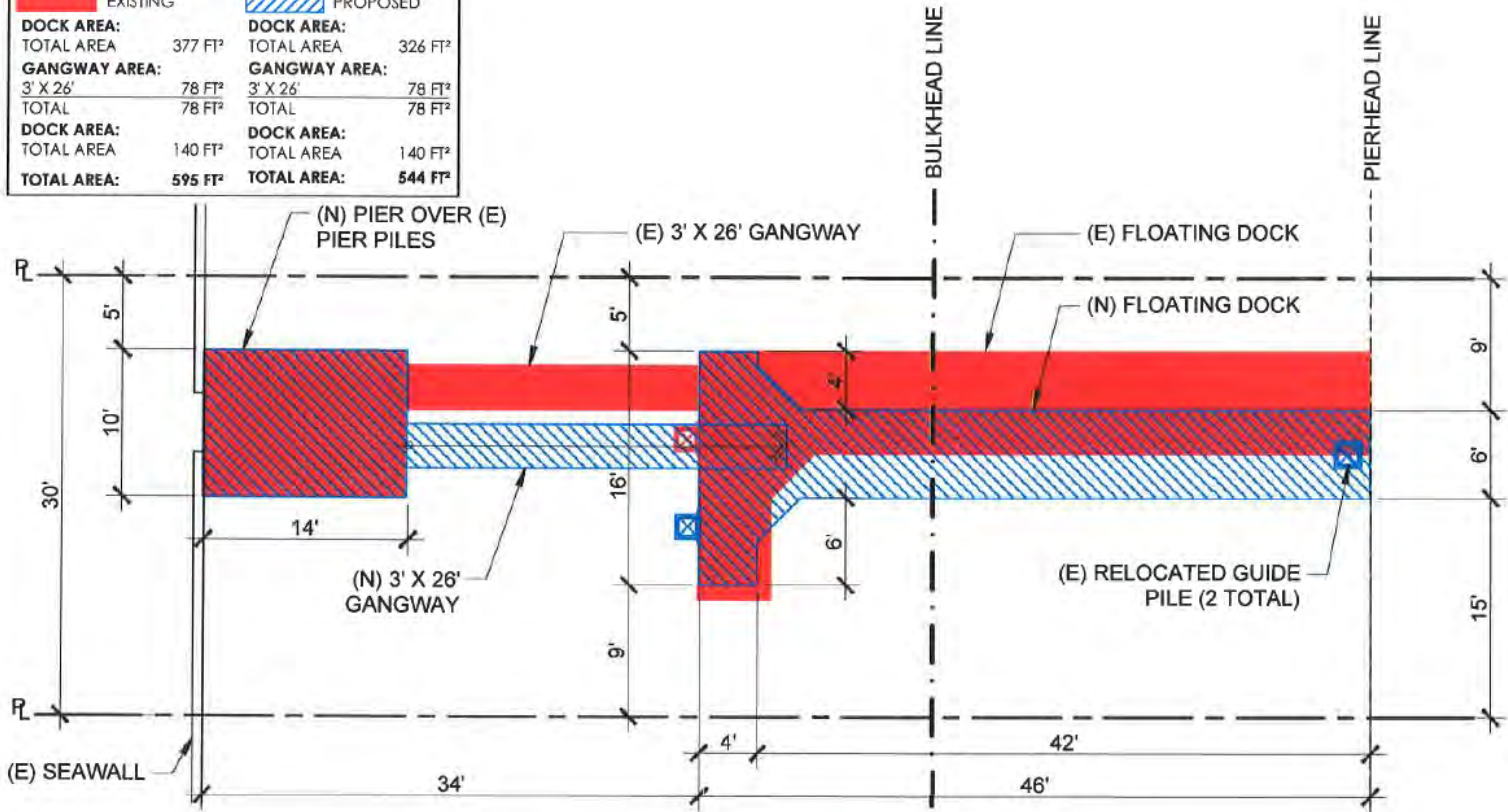

Exhibit 2 – Project Plans

LEGEND		EXISTING		PROPOSED	
DOCK AREA:					
TOTAL AREA	377 FT ²				
GANGWAY AREA:					
3' X 26'	78 FT ²				
TOTAL	78 FT ²				
DOCK AREA:					
TOTAL AREA	140 FT ²				
TOTAL AREA:	595 FT²				
DOCK AREA:					
TOTAL AREA	326 FT ²				
GANGWAY AREA:					
3' X 26'	78 FT ²				
TOTAL	78 FT ²				
DOCK AREA:					
TOTAL AREA	140 FT ²				
TOTAL AREA:	544 FT²				



EXISTING/PROPOSED



CLIENT	JOHN/TINA DEVIR	RO	—	1.0	7/13/21
		DRAWN	CHECKED	REVISION	DATE

SITE
508 VIA LIDO NORD, NEWPORT BEACH, CA 92663

AMENDMENTS			
REV	DESCRIPTION	BY	DATE

SWIFT SLIP DOCK & PIER BUILDERS, INC.
6351 Industry Way, Westminster, CA 92683
Phone: (949) 631-3121 Fax: (714) 509-0618