

CALIFORNIA COASTAL COMMISSION

SAN DIEGO DISTRICT OFFICE
7575 METROPOLITAN DRIVE, SUITE 103
SAN DIEGO, CA 92108-4402
VOICE (619) 767-2370
FAX (619) 767-2384



W18b

6-21-0843 (Cabrillo Power I LLC)

September 7, 2022

EXHIBITS

Table of Contents

Exhibit 1: Location Map

Exhibit 2: Existing Uses

Exhibit 3: Tentative Parcel Map

Exhibit 4: Open Space Deed Restricted Areas

Exhibit 5: CDP#6-12-003 Sewer Lift Station Revegetation Plan

Exhibit 6: Encina Power Station Precise Development Plan constraints map

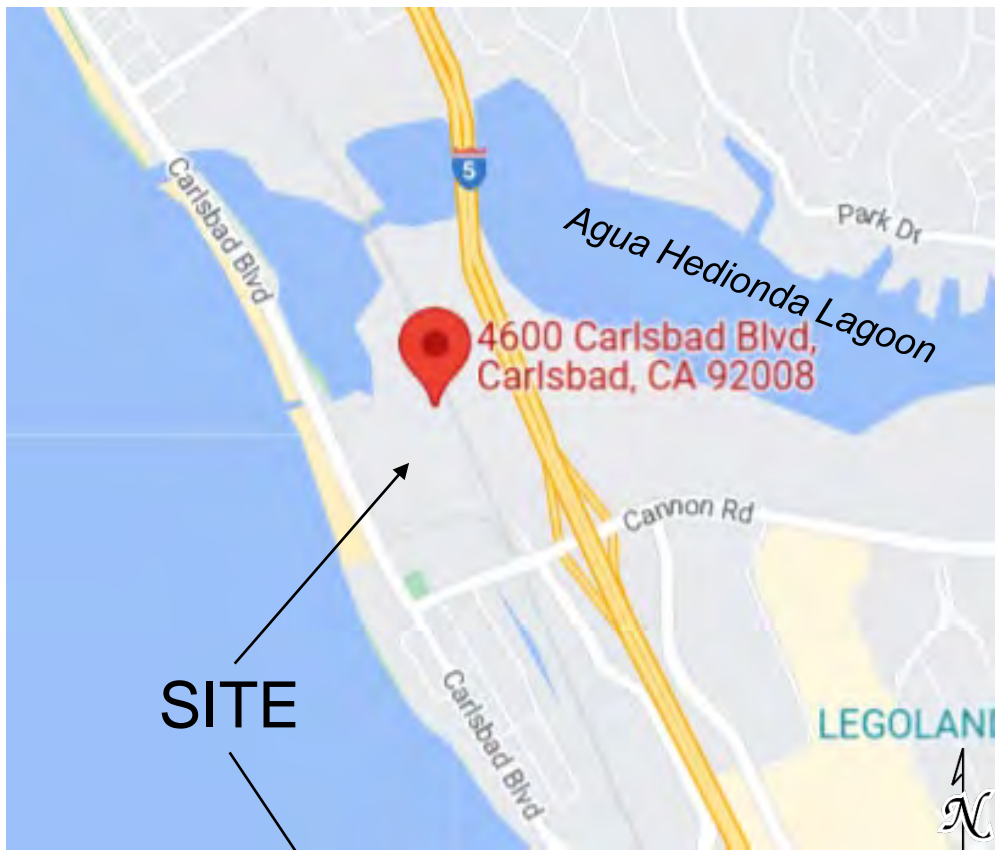

SITE

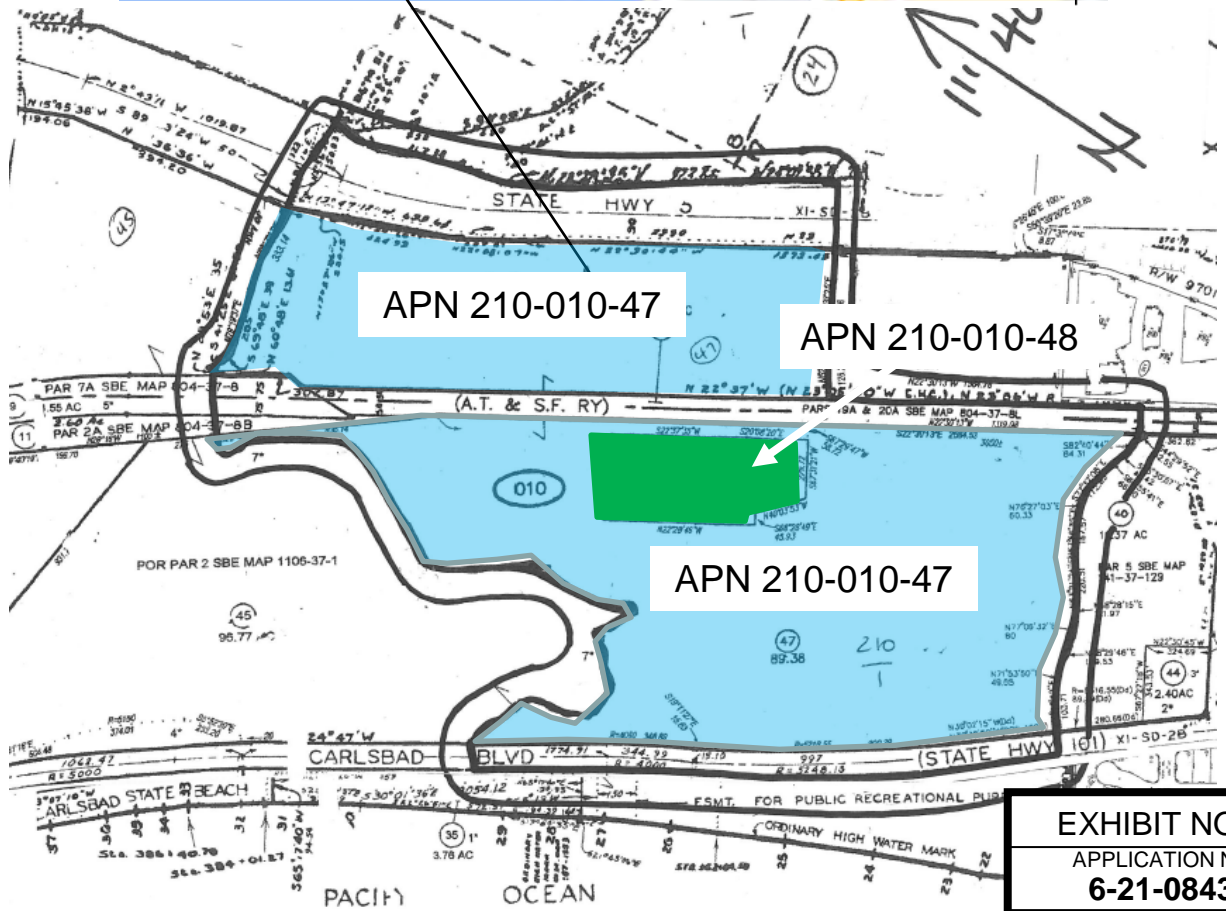

EXHIBIT NO. 1
APPLICATION NO. 6-21-0843
Location Map
 California Coastal Commission



Sewer lift station

Carlsbad Energy Center power station

Carlsbad Aquafarms

Desalination plant

Temporary fire station

SDG&E switching yard

Decommissioned power plant (currently demolished)

EXHIBIT NO. 2
APPLICATION NO.
6-21-0843
Existing Uses

Agua Hedionda Lagoon

Carlsbad Blvd

Interstate 5

Parcel 4
3.16 ac

Parcel 3
28.91 ac

Parcel 1
5.7 ac

Parcel 2
57.35 ac

EXHIBIT NO. 3

APPLICATION NO.

6-21-0843

Tentative Parcel Map



California Coastal Commission

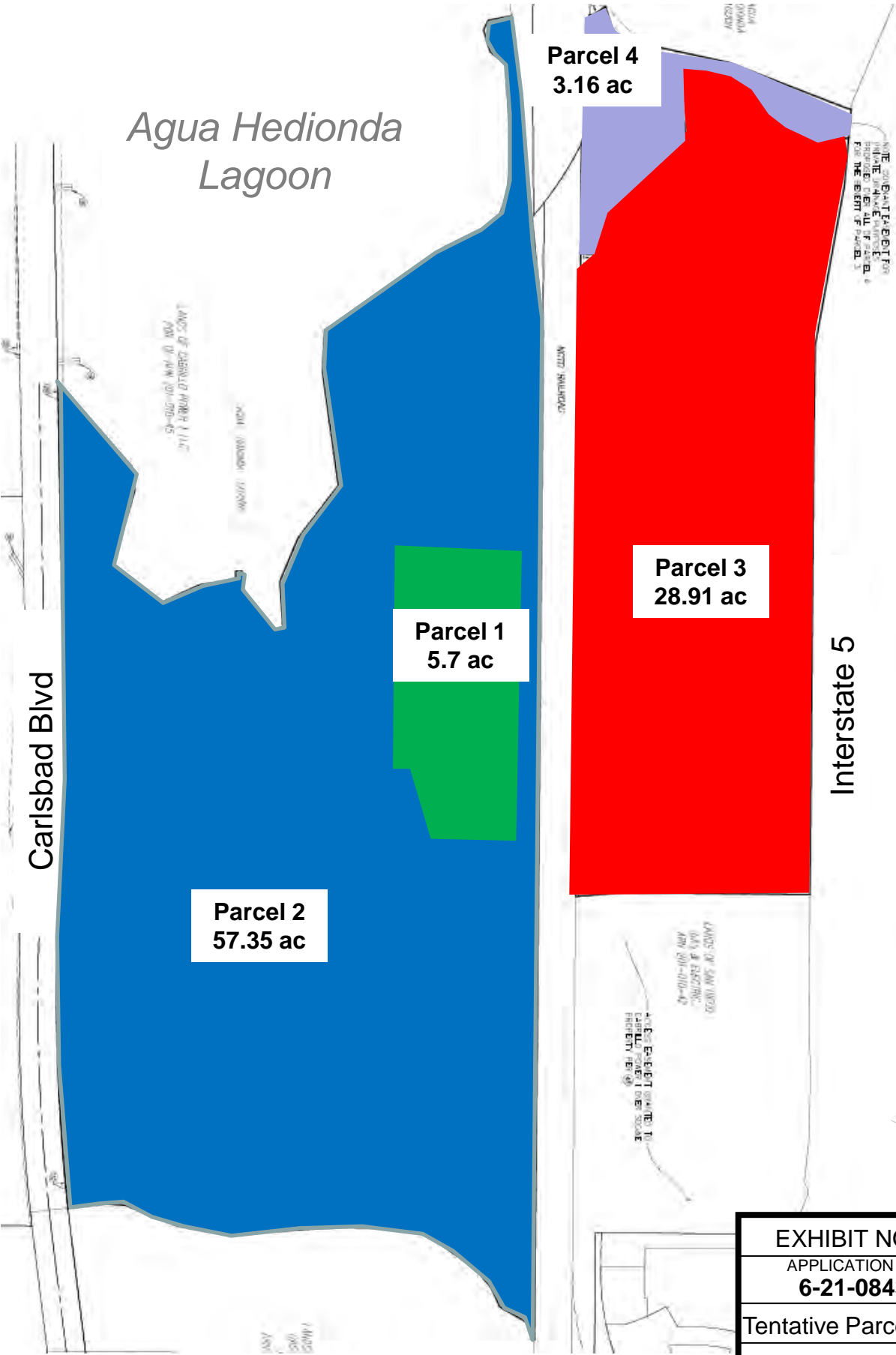

OPEN SPACE DEED RESTRICTED AREAS



Source: Esri, Maxar, GeoEye, Earthstar Geographics, CNES/Airbus DS, USDA, USGS, AeroGRID, IGN, and the GIS User Community

Open Space Deed Restricted Areas

- CSS Habitat and 20' Buffer
- 100' Wetland Buffer
- Top of Steep Slope

Proposed New Parcel Boundaries



N

0 200 400 800 Feet

0 50 100 200 Meters

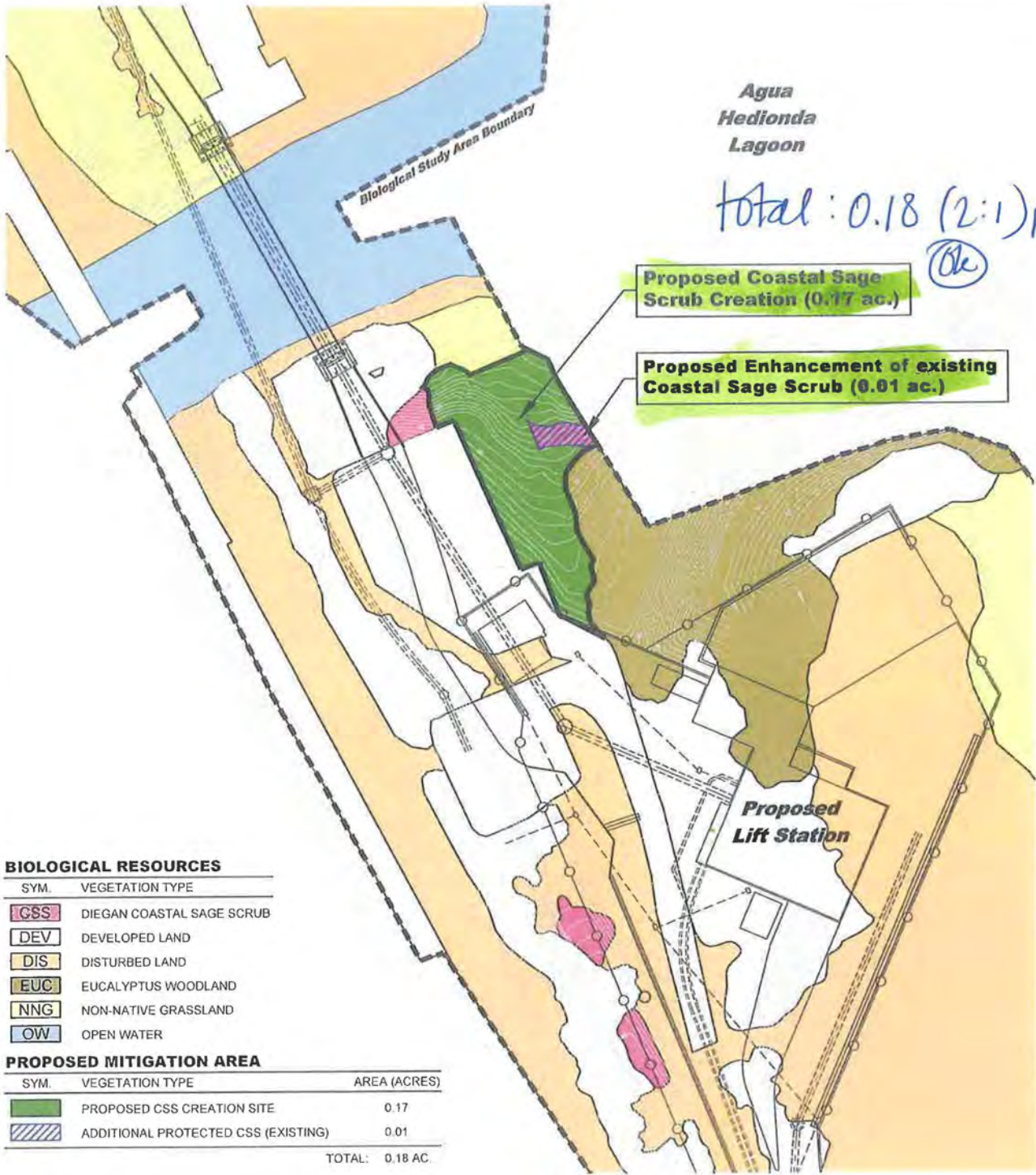

FIGURE 3

Existing Biological Resources with Proposed CSS Mitigation Site

Agua Hedionda Lift Station & Sewer Force Main
Carlsbad, California

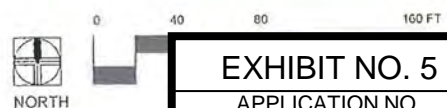
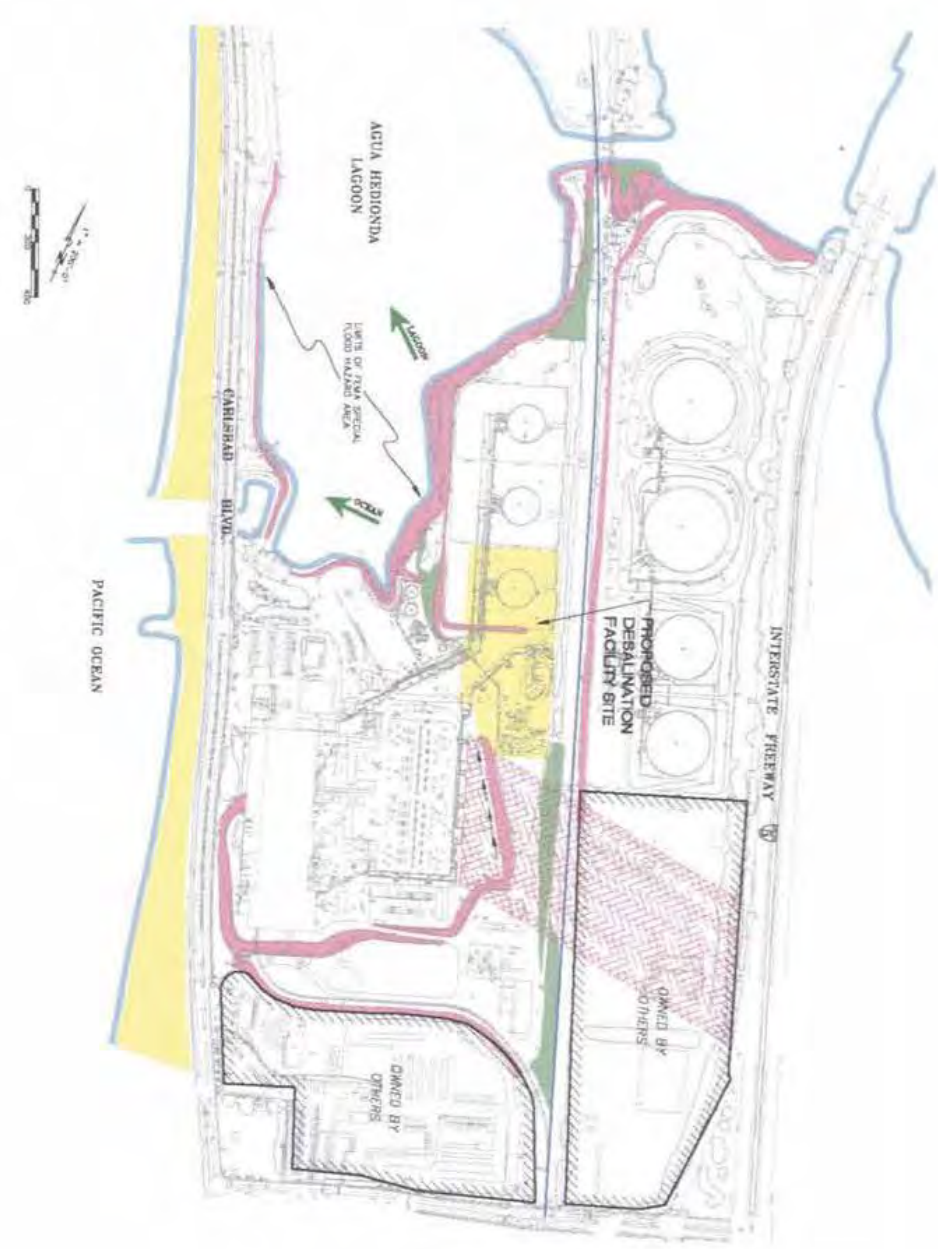

EXHIBIT NO. 5
APPLICATION NO. 6-21-0843
CDP#6-12-003 Revegetation Map
California Coastal Commission



LEGEND

(Symbol)	WALL FOOT LINES
(Symbol)	EXISTING WAYS
(Symbol)	PROPOSED WAYS
(Symbol)	BOUNDARY OF ACQUISITION
(Symbol)	BOUNDARY OF OWNERSHIP
(Symbol)	20-FOOT BUFFER
(Symbol)	OWNER'S TRAIL AND ALLEYS
(Symbol)	WATER WORKS INTERFERENCES
(Symbol)	UTILITIES
(Symbol)	MATERIALS STORAGE
(Symbol)	INDUSTRIAL, WAREHOUSE, OFFICE
(Symbol)	CONCRETE, METAL COMPLEMENTS EXISTING ON THE FACILITY SITE
(Symbol)	REINFORCED CONCRETE
(Symbol)	WOOD
(Symbol)	ASPHALT
(Symbol)	GRAVEL
(Symbol)	LAND SUBJECT TO ALTERNATIVE TRANSPORTATION
(Symbol)	REINFORCED CONCRETE
(Symbol)	ASPHALT
(Symbol)	PROPOSED DESALINATION FACILITY SITE

EXHIBIT NO. 6
 APPLICATION NO.
6-21-0843

Encina Power Station
 constraints plan

California Coastal Commission