

## **CALIFORNIA COASTAL COMMISSION**

SOUTH CENTRAL COAST AREA  
89 SOUTH CALIFORNIA ST., SUITE 200  
VENTURA, CA 93001  
(805) 585-1800



# **W13.1a**

**UCS-NOID-0002-23 (Baseball Stadium Turf)**

**December 13, 2023**

### **EXHIBITS**

**Exhibit 1** – Vicinity Map

**Exhibit 2** – Aerial Overview

**Exhibit 3** – Proposed Project Plans

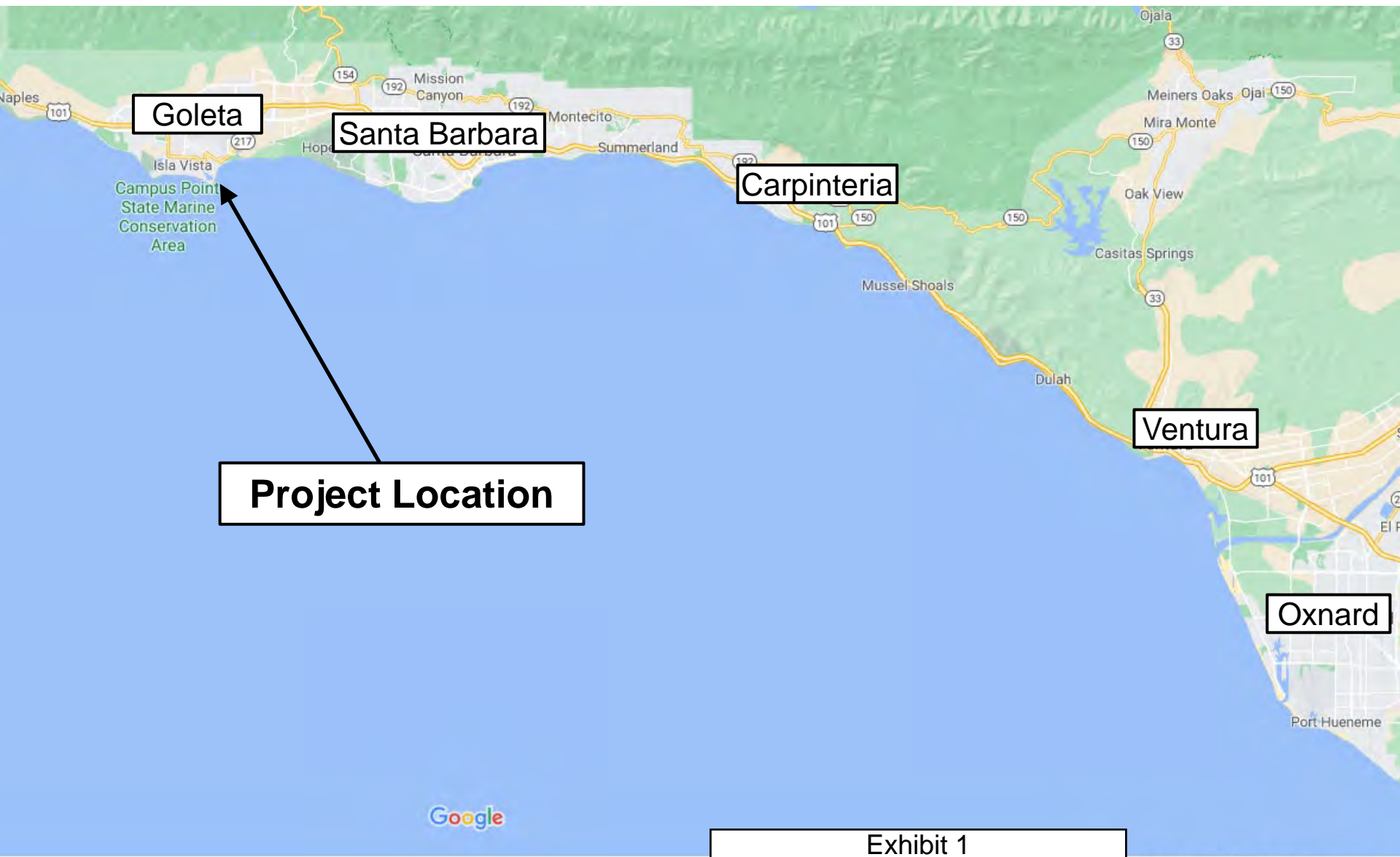

**Project Location**

Exhibit 1  
UCS-NOID-0002-23  
Vicinity Map



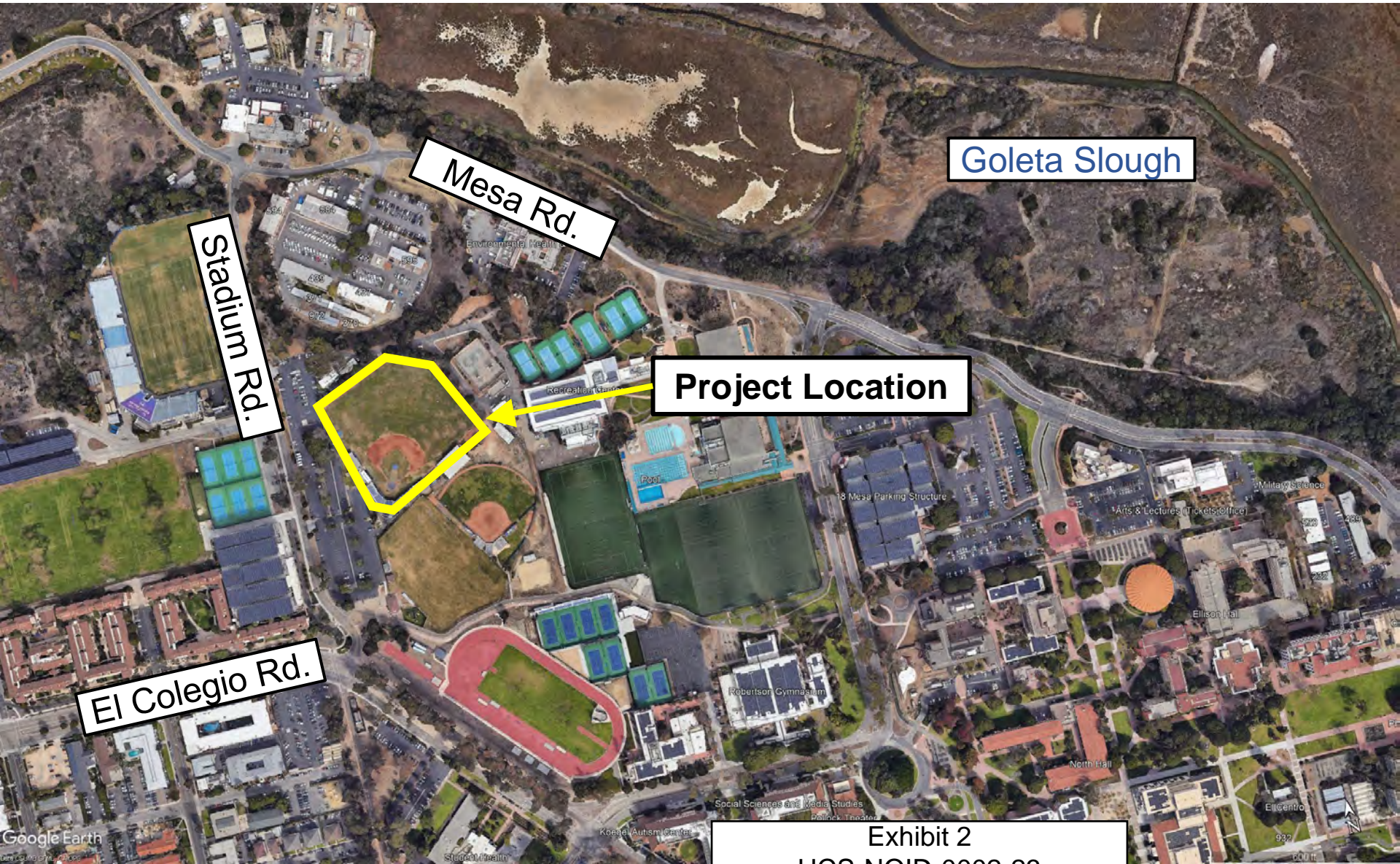

Goleta Slough

Mesa Rd.

Stadium Rd.

Project Location

El Colegio Rd.

Exhibit 2  
UCS-NOID-0002-23  
Aerial Overview



# IMPORTANT NOTICE

ALL EXISTING UTILITY LOCATIONS ARE APPROXIMATE.  
CONTRACTOR IS TO NOTIFY UNDERGROUND SERVICE  
ALERT TWO WORKING DAYS PRIOR TO STARTING ANY  
EXCAVATION OR RESURFACING.

CALL TOLL FREE 1-800-422-4133

## GENERAL CONSTRUCTION NOTES THIS SHEET:

- PROTECT ALL EXISTING IMPROVEMENTS AND INFRASTRUCTURE WITHIN WORK AREA (TYPICAL, UNLESS OTHERWISE NOTED).
- PROTECT EXISTING UTILITIES WITHIN WORK AREA. NOTIFY UNDERGROUND SERVICE ALERT AT LEAST 2 WORKING DAYS IN ADVANCE OF BEGINNING EXCAVATION AT 1-800-422-4133.
- EXISTING BURIED CONDUITS, PIPES AND/OR STRUCTURES KNOWN TO THE ENGINEER ARE SHOWN ON THE DRAWINGS BASED ON RECORD DRAWING INFORMATION OR INPUT FROM OTHERS. THE LOCATIONS OF THESE SHOWN ARE APPROXIMATE (SCHEMATIC ONLY) AND MOST LIKELY OTHERS EXISTING WHICH HAVE NOT BEEN SHOWN. INVESTIGATE, LOCATE AND MARK ALL EXISTING BURIED CONDUITS, PIPES AND STRUCTURES PRIOR TO START OF GRADING OR TRENCHING. PROTECT AND MAINTAIN IN SERVICE ALL SUCH FACILITIES UNTIL OTHERWISE APPROVED BY WRITING BY OWNER.
- HORIZONTAL LOCATIONS OF EXISTING BURIED CONDUITS, PIPES AND/OR STRUCTURES AS SHOWN ON THE DRAWINGS OR AS MARKED IN THE FIELD ARE APPROXIMATE ONLY. VERTICAL LOCATIONS ARE NOT KNOWN BEFORE BEGINNING TRENCHING OR GRADING. LOCATE AND EXPOSE ALL BURIED CONDUITS, PIPES AND/OR STRUCTURES WHICH CROSS OR OTHERWISE ANY CONFLICT WITH NEW IMPROVEMENTS OR WHICH ARE TO BE JOINED BY NEW CONSTRUCTION AND HAVE HORIZONTAL AND VERTICAL LOCATIONS DETERMINED BY SURVEY. PROVIDE RESULTS OF THIS INVESTIGATION AND SURVEY TO ENGINEER FOR REVIEW BEFORE WORK IS COMMENCED. ALLOW FIVE (5) WORKING DAYS FOR THE REVIEW. THIS MAY BE REQUIRED DEPENDING ON COMPLETENESS OF INFORMATION PROVIDED AND EXTENT OF CONFLICTS, IF ANY.
- RETAIN A LICENSED LAND SURVEYOR TO STAKE HORIZONTAL AND VERTICAL CONTROL FOR LAYOUT OF THE WORK. FOR SURVEYING LOCATIONS OF EXISTING BURIED PIPELINES, CONDUITS AND STRUCTURES AND FOR GRADE CONFIRMATION WHERE REQUIRED DURING CONSTRUCTION. CONFIRM CONTROL DATA WITH TOPOGRAHIC SURVEYING SURVEYOR (EMPLOYER LAND SURVEYING COMPANY) PRIOR TO STARTING WORK. IN ADDITION, CHECK STAKING AT KEY LOCATIONS BY SCALES DISTANCES AND TAPING FROM EXISTING FEATURES SHOWN ON PLAN.
- ALL RECLAIMED WATER LINES WITHIN THE FIELD TO BE RE-ANCHORED IN PLACE. CONTRACTOR TO COORDINATE WITH UCBS AND COLETA WATER DISTRICT PRIOR TO CUTTING AND CAPPING RECLAIMED WATER LINE.

## SPECIFIC CONSTRUCTION NOTES THIS SHEET:

(NUMBERED ITEM BELOW CORRESPONDS TO NUMBER WITHIN HEXAGON ON DRAWING)

### PROTECTIONS/REMOVALS

- PROTECT EXISTING STRUCTURE TO REMAIN.
- PROTECT EXISTING PAVEMENT TO REMAIN.
- NOT USED.
- PROTECT EXISTING UTILITY AND/OR PULL BOX TO REMAIN.
- PROTECT EXISTING FENCE AND / OR GATE.
- PROTECT EXISTING 24" CATCH BASIN TO REMAIN.
- NOT USED.

### SITE IMPROVEMENTS

- CONSTRUCT ARTIFICIAL TURF PER MANUFACTURER'S RECOMMENDATIONS AND DETAIL 7 / CD-1. GRADE AREA AND PERIMETER SHALL BE UNDER CONSTRUCTION TESTING OF GEOTECHNICAL ENGINEER.
- CONSTRUCT PITCHERS MOUND PER ARTIFICIAL TURF MANUFACTURER'S RECOMMENDATIONS. SEE DETAILS 1 AND 2 / CD-1.
- CONSTRUCT BATTERY BOX FOR ARTIFICIAL TURF MANUFACTURER'S RECOMMENDATIONS. SEE DETAIL 3 / CD-1.
- CONSTRUCT FENCE AND/OR GATE PER SPECIFICATIONS.
- CONSTRUCT CONCRETE PAVEMENT PER DETAIL 5 / CD-1.
- CONSTRUCT EDGE HEADER PER DETAIL 6 / CD-1.
- CONSTRUCT BASE INSERT PER DETAIL 4 / CD-1.
- NOT USED.

### PERIMETER DRAIN

- CONSTRUCT 4" AREA DRAIN IN CONCRETE.
- CONSTRUCT 4" PERIMETER DRAIN IN TRENCH PER DETAIL 8 / CD-1.
- CONSTRUCT 12" PERIMETER DRAIN IN TRENCH PER DETAIL 8 / CD-1. USING 12" HOPE PIPE HAVING CLASS 1 CIRCULAR PERFORATIONS.
- CONSTRUCT 12" PERIMETER DRAIN IN TRENCH PER DETAIL 8 / CD-1. USING 12" HOPE PIPE HAVING CLASS 1 CIRCULAR PERFORATIONS.
- CONSTRUCT 12" PERIMETER DRAIN IN TRENCH PER DETAIL 8 / CD-1. USING 12" HOPE PIPE HAVING CLASS 1 CIRCULAR PERFORATIONS.
- CONSTRUCT CONNECTION TO EXISTING 24" CATCH BASIN. CONTRACTOR TO VERIFY LOCATION AND INVERT IN FIELD PRIOR TO CONSTRUCTION.
- CONSTRUCT CONNECTION TO EXISTING 24" CATCH BASIN. CONTRACTOR TO VERIFY LOCATION AND INVERT IN FIELD PRIOR TO CONSTRUCTION.
- CONSTRUCT 12" PERIMETER DRAIN IN TRENCH PER DETAIL 8 / CD-1.
- NOT USED.

### PERIMETER

- INSTALL FIELD WATER SUPPLY BOX AND VALVE PER DETAIL 10 / CD-1 AT DUGOUT LOCATIONS AND DETAIL 12 / CD-2 FOR PITCHERS MOUND LOCATION.
- INSTALL 12" PVC WATER LINE WITH MANHOLE 4 FT. COVER IN TRENCH PER DETAIL 9 / CD-1.
- CONNECT WATER LINE TO EXISTING WATER LINE WITH FITTINGS AS NECESSARY. PROTECT EXISTING WATER LINE.
- INSTALL 12" BACKFLOW PREVENTER PER MANUFACTURER'S RECOMMENDATIONS.
- NOT USED.

### DRY UTILITIES

- PROPOSED ELECTRICAL LINE PER OTHERS. CONTRACTOR'S ELECTRICAL TO FINALIZE CONDUIT SIZING AT TIME OF CONSTRUCTION. CONTRACTOR'S ELECTRICAL TO FINALIZE POINT OF CONNECTION AT TIME OF CONSTRUCTION WITH COORDINATION WITH UCBS FACILITIES GROUP.
- PROPOSED ELECTRICAL BOX PER DETAIL 11 / CD-2.

REVISIONS	
NO.	DATE

FLOWERS & ASSOCIATES, INC.

118 W. Grand Pacific Street

San Francisco, CA 94102

Telephone (415) 442-2224

DATE: 08/11/2009

BY: [Signature]

DATE: 08/11/2009

**SITE IMPROVEMENT PLAN**

SITE IMPROVEMENT PLANS

BASEBALL FIELD

UNIVERSITY OF CALIFORNIA SANTA BARBARA

COUNTY OF SANTA BARBARA, CALIFORNIA

**C-1**

DATE: 08/11/2009

SHEET: 3 OF 7

FM230236MED/245-55

2014\_SBFIELD IMPROVEMENTS.DWG

W.O. 22014

## Exhibit 3 UCS-NOID-0002-23 Proposed Project Plans

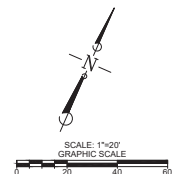



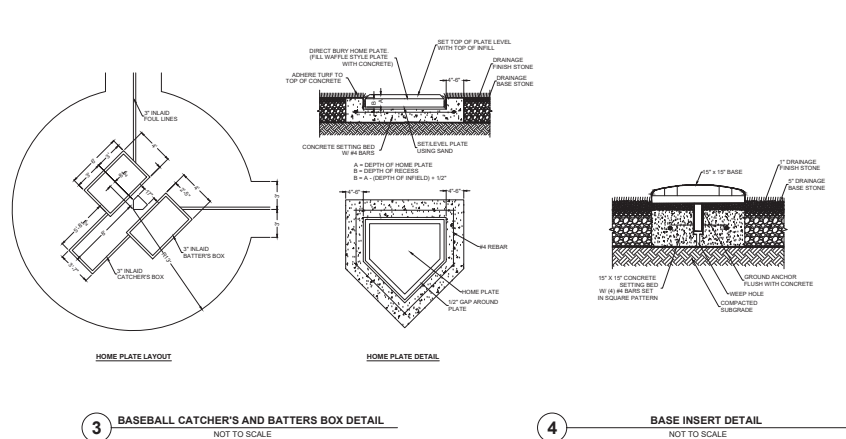

**2** 10" BASEBALL PITCHERS MOUND DETAIL  
NOT TO SCALE

**3 BASEBALL CATCHER'S AND BATTERS BOX DETAIL**  
NOT TO SCALE

**4** **BASE INSERT DETAIL**  
NOT TO SCALE

IF JOINING EXISTING WALKWAY OR IF ADJACENT TO EXISTING OR PROPOSED STRUCTURE OR CURB, DRILL & EPOXY GROUT #4 DOWEL @ 16" O.C. INTO 3/4" DIA HOLE IN WALK, STRUCTURE, OR CURB.

WHERE CALLED FOR ON DRAWINGS, CONSTRUCT EXPANSION JOINT BETWEEN WALKWAY AND EXISTING OR PROPOSED STRUCTURE PER 2/CD-1 WITH FIXED END OF DOWEL INTO WALKWAY OR STRUCTURE

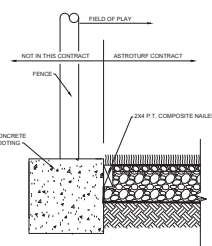

**5** **WALKWAY WITH THICKENED EDGE DETAIL**  
NOT TO SCALE

**6** **TURF EDGE HEADER DETAIL**  
NOT TO SCALE

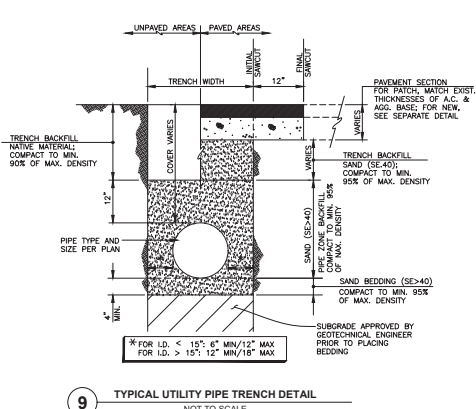

**8** **FIELD PERIMETER DRAIN DETAIL**  
NOT TO SCALE

**9** TYPICAL UTILITY PIPE TRENCH DETAIL  
NOT TO SCALE

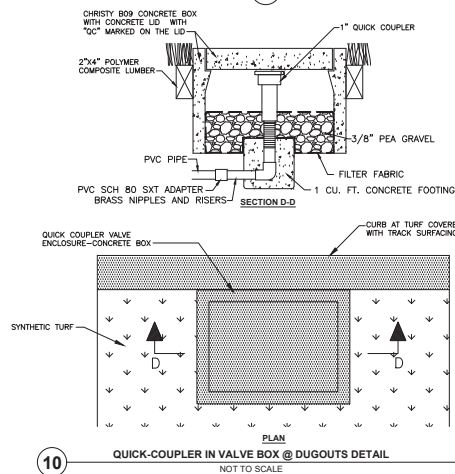

**10** QUICK-COUPLER IN VALVE BOX @ DUGOUTS DETAIL  
NOT TO SCALE



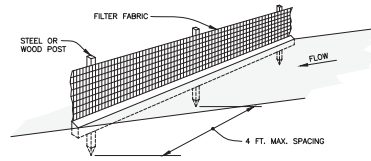

SPACING PLAN

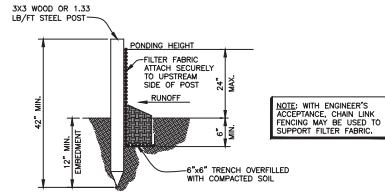

ANCHORING PLAN  
SILT FENCE DETAIL  
NOT TO SCALE

1

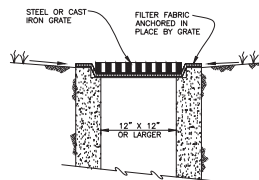
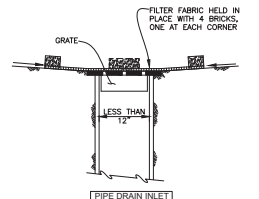

(PRE-CAST OR CAST-IN-PLACE BASIN)

NOTES:

1. SILT TRAPS SHALL BE MAINTAINED AND CLEANED BY CONTRACTOR AFTER RAINFALL AND AS NECESSARY TO MAINTAIN INFLOW TO BASIN

2

SILT TRAP AT DRAIN INLET DETAIL  
NOT TO SCALE

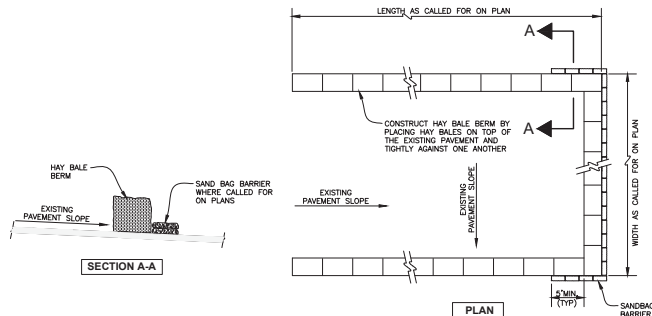

3

POLLUTION CONTAINMENT AREA STRAW BERM DETAIL  
NOT TO SCALE

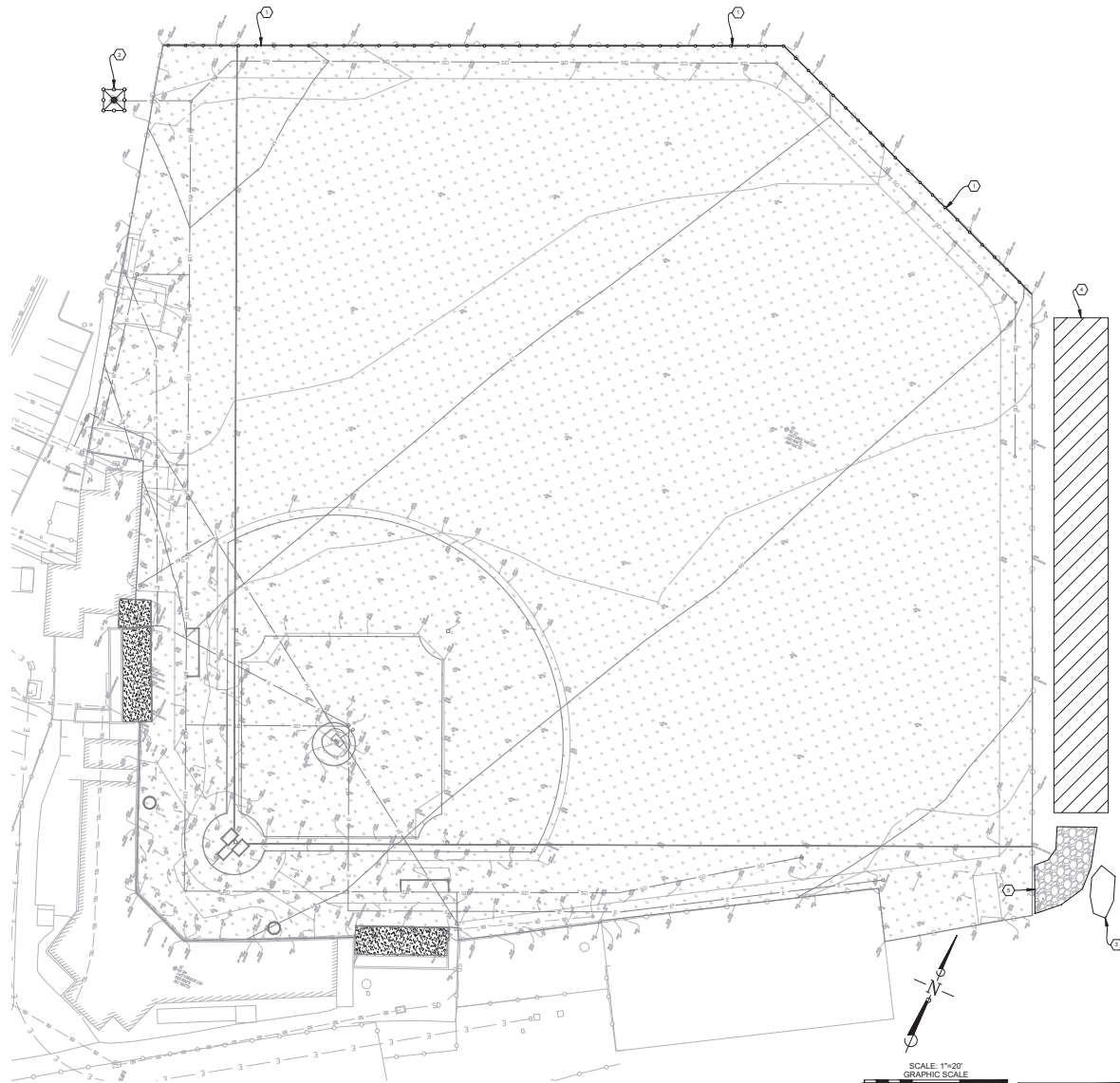

STORM WATER POLLUTION PREVENTION CONSTRUCTION NOTES THIS SHEET:

1. INSTALL SILT FENCE PER DETAIL 1 ON THIS SHEET.
2. CONSTRUCT TEMPORARY SILT TRAP AT DRAIN INLET PER DETAIL 2 ON THIS SHEET OR FILTER SILT TRAP PER MANUFACTURER'S INSTALLATION INSTRUCTIONS. (TYPICAL, NOT ALL NECESSARY LOCATIONS ARE SHOWN).
3. CONSTRUCT POLLUTION CONTAINMENT AREA PER DETAIL 3 ON THIS SHEET. ACTUAL LOCATION(S) DETERMINED BY CONTRACTOR.
4. EQUIPMENT AND MATERIALS STAGING AREA. ACTUAL LOCATION(S) DETERMINED BY CONTRACTOR.
5. CONSTRUCT CLASS 2 BASE ROCK CONSTRUCTION STAGING ENTRANCE AS SHOWN ON PLAN.

EROSION CONTROL PLAN  
SITE IMPROVEMENT PLANS  
UNIVERSITY OF CALIFORNIA SANTA BARBARA  
COUNTY OF SANTA BARBARA, CALIFORNIA

EC-1

DATE: 08/11/2023  
SHEET: 1 OF 1

W.O. 22014

FLOWERS & ASSOCIATES, INC.  
118 W. Camino Pueblo Street  
Santa Barbara, CA 93101  
Telephone (805) 962-2224  
BY: [Signature] DATE: 08/11/2023

No. 71335  
DATE: 08/11/2023

NO.	REVISIONS	DATE	APPROVED
1			
2			
3			
4			
5			